



Benham & Reeves

Lensbury Avenue, Fulham, SW6

£625 per week, £2,708 per month + fees

 2 Bedrooms  2 Bathrooms  Furnished

A spacious, fashionable interior designed fourth floor apartment with onsite gym located in Imperial Wharf. The development is positioned nearby the amenities of Fulham and is within walking distance of Imperial Wharf Overground Station.

Please [click here](#) for full detail

Property features

2 Bedrooms | 2 Bathrooms | Reception | Furnished | Fully Fitted Kitchen | EPC-C | 24-Hour Concierge | Gym | Nearby Imperial Wharf Overground

For more information about this property,
please call our Fulham branch on

020 7348 7620

Redress & Client Money Protection :

Benham and Reeves are members of The Property Ombudsman redress scheme and have Client Money protection with ARLA Propertymark. You can find more information on our website at <https://www.benhamandreeves.com/membership/>



Benham & Reeves



Lensbury Avenue, Fulham, SW6

£625 per week, £2,708 per month + fees

www.benhams.com

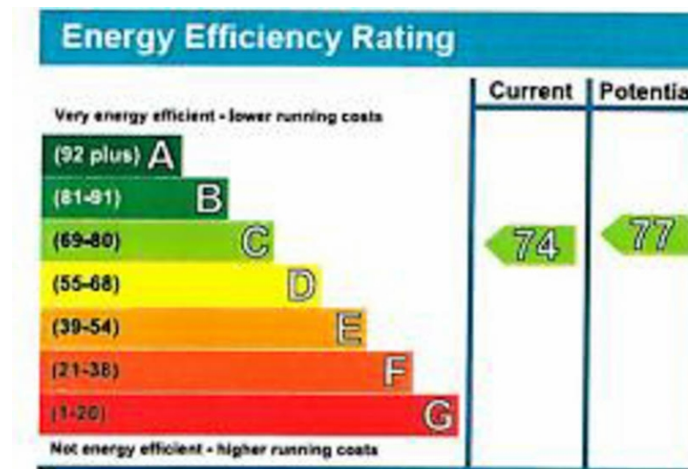
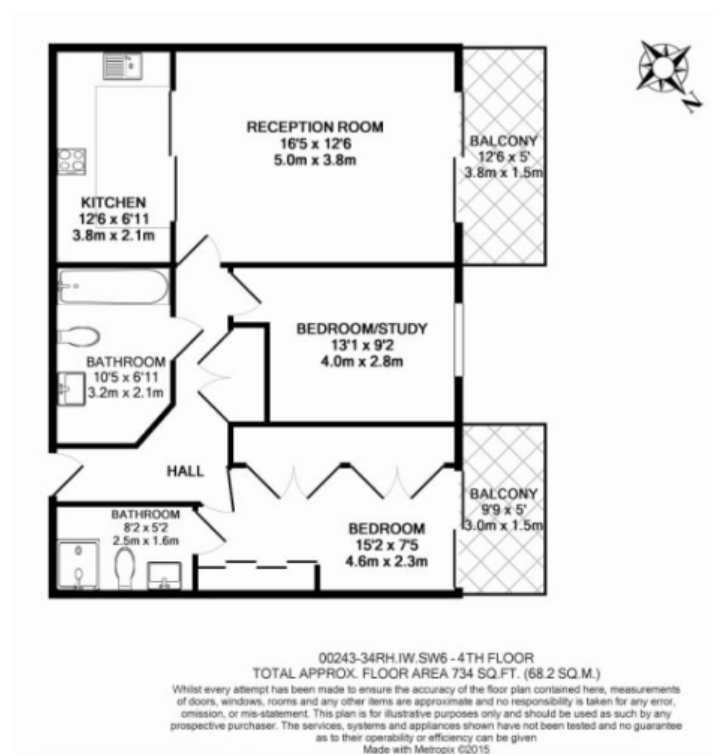

London branches open six days a week Mon - Sat

Canary Wharf | City | Colindale | Dartmouth Park | Ealing | Fulham
Hammersmith | Hampstead | Highgate | Hyde Park | Kensington | Kew
Knightsbridge | Nine Elms | Shoreditch | Southall | Surrey Quays
Wapping | Wembley | White City | Woolwich

International offices

China | Hong Kong SAR | India | Indonesia | Qatar | Malaysia | Middle East | Pakistan
Singapore | South Africa | Thailand | Turkey



Benham & Reeves