



Benham & Reeves

Park Street, Fulham, SW6

£1,000 per week, £4,333 per month + fees

 3 Bedrooms  2 Bathrooms  Furnished

Large bright 5th floor apartment with secure underground parking and exclusive residents' fitness suite, situated in a popular Riverside development in Fulham. Close to The River Thames and a short walk from Imperial Wharf Overground station.

Please [click here](#) for full detail

Property features

3 Bedrooms | 2 Bathrooms | Reception | Furnished | Fully fitted kitchen | EPC-C | 24 hour concierge | On site gym | Nearby Imperial wharf station

For more information about this property,
please call our Fulham branch on

020 7348 7620

Redress & Client Money Protection :

Benham and Reeves are members of The Property Ombudsman redress scheme and have Client Money protection with ARLA Propertymark. You can find more information on our website at <https://www.benham.com/membership/>



Benham & Reeves



Park Street, Fulham, SW6

£1,000 per week, £4,333 per month + fees

www.benhams.com

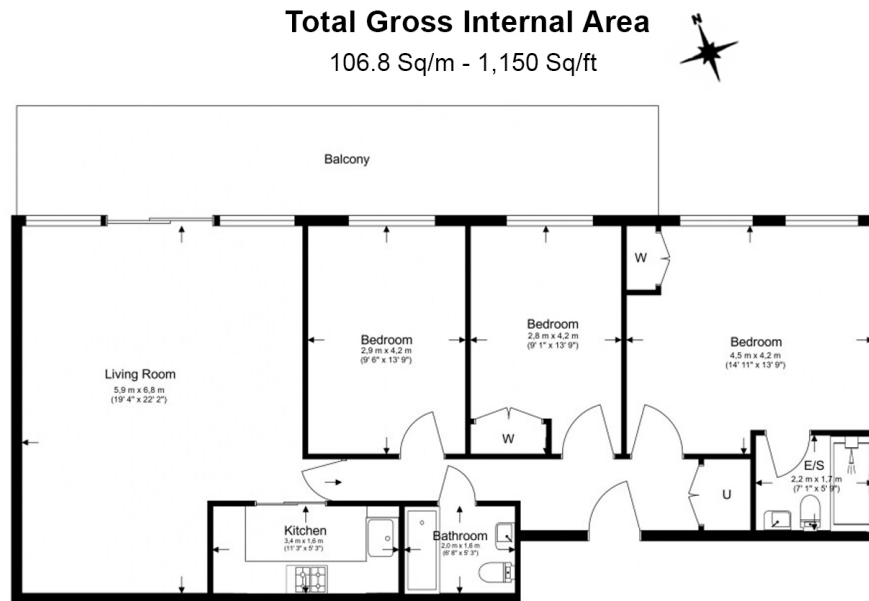

Floor Plan measurements are approximate and are for illustrative purposes only. While we do not doubt the floor plans accuracy, we make no guarantee, warranty or representation as to the accuracy and completeness of the floor plan.

Energy Efficiency Rating		
	Current	Potential
Very energy efficient - lower running costs		
(92 plus) A		
(81-91) B		
(69-80) C	76	78
(55-68) D		
(39-54) E		
(21-38) F		
(1-20) G		
Not energy efficient - higher running costs		
England & Wales		EU Directive 2002/91/EC

London branches open six days a week Mon - Sat

Canary Wharf | City | Colindale | Dartmouth Park | Ealing | Fulham
Hammersmith | Hampstead | Highgate | Hyde Park | Kensington | Kew
Knightsbridge | Nine Elms | Shoreditch | Southall | Surrey Quays
Wapping | Wembley | White City | Woolwich

International offices

China | Hong Kong SAR | India | Indonesia | Qatar | Malaysia | Middle East | Pakistan
Singapore | South Africa | Thailand | Turkey



Benham & Reeves