



Benham & Reeves

Lensbury Avenue, Fulham, SW6

£773 per week, £3,350 per month + fees

 2 Bedrooms  2 Bathrooms  Unfurnished

Stunning modern ground floor apartment situated within a prestigious development, with exclusive amenities. Underground parking is offered by separate negotiation. Located within easy reach of Chelsea and King's Road, close to Imperial Wharf Train Station.

Please [click here](#) for full detail

Property features

2 Bedrooms | 2 Bathrooms | Reception | Unfurnished | Fitted Kitchen | EPC-B | Two Balconies | 24hr Concierge, Gym & Pool | Nearby Imperial Wharf Overground Station

For more information about this property,
please call our Fulham branch on

020 7348 7620

Redress & Client Money Protection :

Benham and Reeves are members of The Property Ombudsman redress scheme and have Client Money protection with ARLA Propertymark. You can find more information on our website at <https://www.benhamandreeves.com/membership/>



Benham&Reeves



Lensbury Avenue, Fulham, SW6

£773 per week, £3,350 per month + fees

www.benhams.com

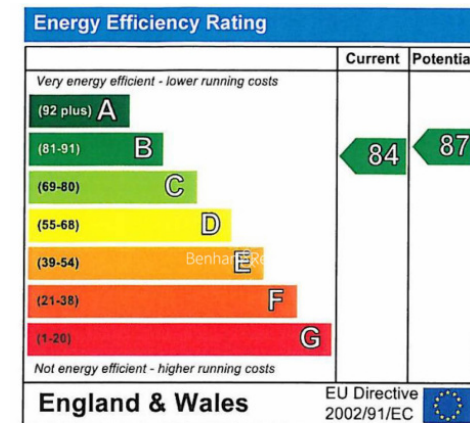
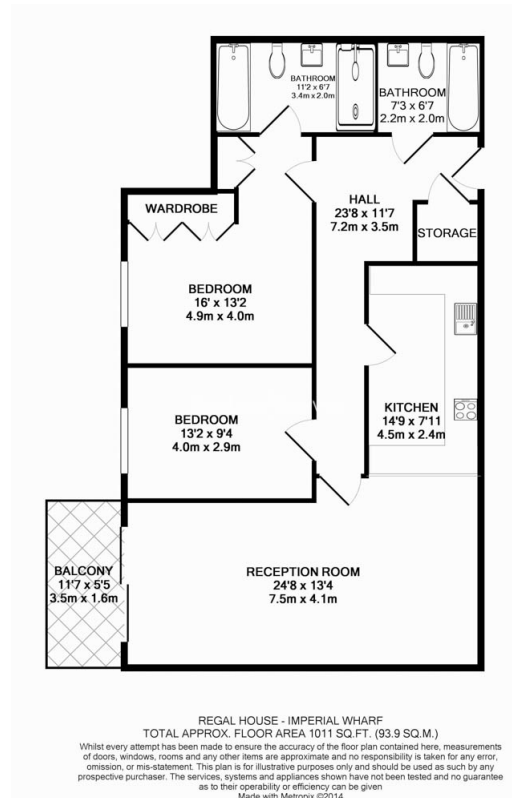

The energy efficiency rating is a measure of the overall efficiency of a home. The higher the rating the more energy efficient the home is and the lower the fuel bills are likely to be.

London branches open six days a week Mon - Sat

Canary Wharf | City | Colindale | Dartmouth Park | Ealing | Fulham
Hammersmith | Hampstead | Highgate | Hyde Park | Kensington | Kew
Knightsbridge | Nine Elms | Shoreditch | Southall | Surrey Quays
Wapping | Wembley | White City | Woolwich

International offices

China | Hong Kong SAR | India | Indonesia | Qatar | Malaysia | Middle East | Pakistan
Singapore | South Africa | Thailand | Turkey



Benham & Reeves