



Benham & Reeves

The Boulevard, Fulham, SW6

£646 per week, £2,800 per month + fees

 2 Bedrooms  2 Bathrooms  Furnished

A vibrant 5th floor apartment with stunning, direct River views, and underground parking, situated in a sought-after Tower in the immensely popular Imperial Wharf development. Ideally located a few steps from Imperial Wharf Mainline train station SHORT LET .

Please [click here](#) for full detail

Property features

2 Bedrooms | 2 Bathrooms | Reception | Furnished | Fitted Kitchen | EPC-C | 24 Hour concierge | Gym | Imperial wharf overground

For more information about this property,
please call our Fulham branch on

020 7348 7620

Redress & Client Money Protection :

Benham and Reeves are members of The Property Ombudsman redress scheme and have Client Money protection with ARLA Propertymark. You can find more information on our website at <https://www.benham.com/membership/>

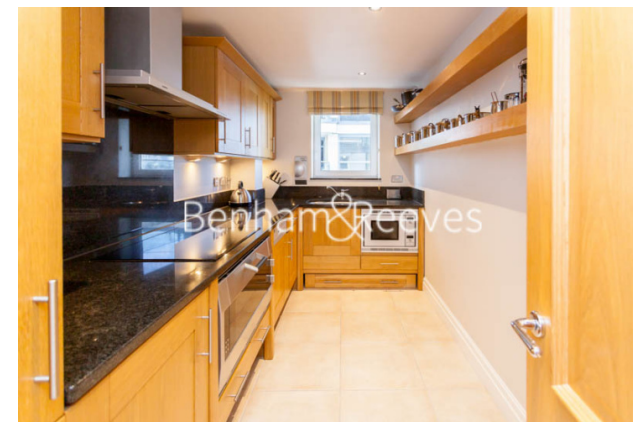

Benham & Reeves



The Boulevard, Fulham, SW6

£646 per week, £2,800 per month + fees

www.benhams.com

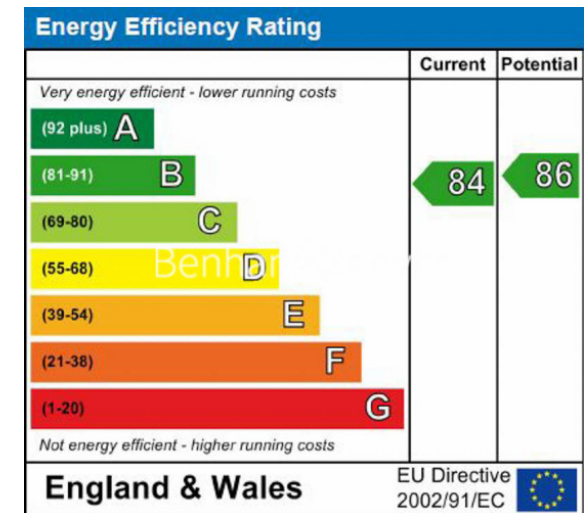
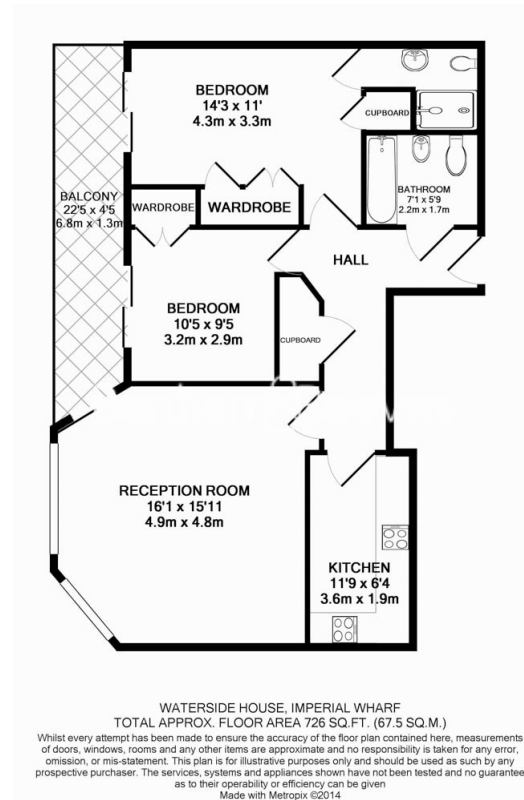

London branches open six days a week Mon - Sat

Canary Wharf | City | Colindale | Dartmouth Park | Ealing | Fulham
Hammersmith | Hampstead | Highgate | Hyde Park | Kensington | Kew
Knightsbridge | Nine Elms | Shoreditch | Southall | Surrey Quays
Wapping | Wembley | White City | Woolwich

International offices

China | Hong Kong SAR | India | Indonesia | Qatar | Malaysia | Middle East | Pakistan
Singapore | South Africa | Thailand | Turkey



Benham & Reeves