



Benham & Reeves

Lensbury Avenue, Fulham, SW6

£1,569 per week, £6,800 per month + fees

 3 Bedrooms  3 Bathrooms  Furnished

A large, impressive 4th floor apartment, with managed car park and scenic River walk, situated in a sought-after development in the vibrant Imperial Wharf. Ideally located close to the amenities on the fashionable King's Road and moments from Imperial Wharf Overground Station.

Please [click here](#) for full detail

Property features

3 Bedrooms | 3 Bathrooms | Reception | Furnished | Fitted Kitchen | EPC-C | Fitness Suite | Lift Access | Nearby Imperial Wharf Station

For more information about this property,
please call our Fulham branch on

020 7348 7620

Redress & Client Money Protection :

Benham and Reeves are members of The Property Ombudsman redress scheme and have Client Money protection with ARLA Propertymark. You can find more information on our website at <https://www.benhams.com/membership/>



Benham & Reeves



Lensbury Avenue, Fulham, SW6

£1,569 per week, £6,800 per month + fees

www.benhams.com

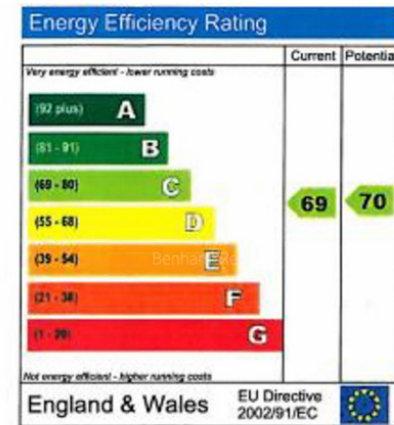
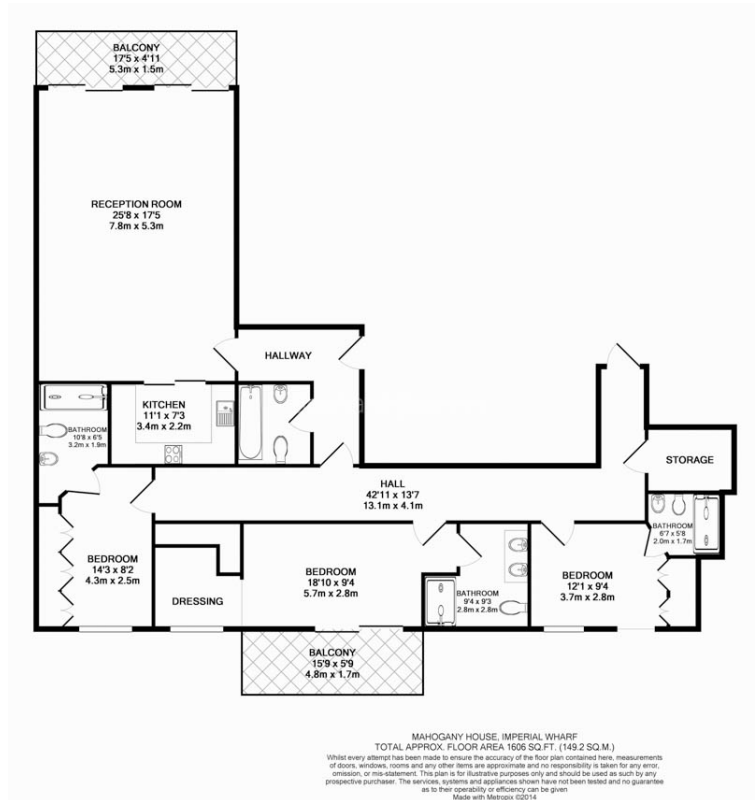

The energy efficiency rating is a measure of the overall efficiency of a home. The higher the rating the more energy efficient the home is and the lower the fuel bills are likely to be.

London branches open six days a week Mon - Sat

Canary Wharf | City | Colindale | Dartmouth Park | Ealing | Fulham
Hammersmith | Hampstead | Highgate | Hyde Park | Kensington | Kew
Knightsbridge | Nine Elms | Shoreditch | Southall | Surrey Quays
Wapping | Wembley | White City | Woolwich

International offices

China | Hong Kong SAR | India | Indonesia | Qatar | Malaysia | Middle East |
Singapore | South Africa | Thailand | Turkey

