



Benham&Reeves

Park Street, Fulham, SW6

£525 per week, £2,275 per month + fees

 Studio  1 Bathroom  Furnished

A contemporary Manhattan apartment set in a landmark riverside development close to the amenities of Fulham and Chelsea. The development is conveniently situated moments away from Imperial Wharf overground station.

Please [click here](#) for full detail

Property features

Manhattan | 1 Bathroom | Open Plan Reception | Furnished | Fitted Kitchen | EPC-C | Balcony | 24 Hour Concierge | Nearby Imperial Wharf (Overground)

For more information about this property,
please call our Fulham branch on

020 7348 7620





Park Street, Fulham, SW6

£525 per week, £2,275 per month + fees

www.benhams.com

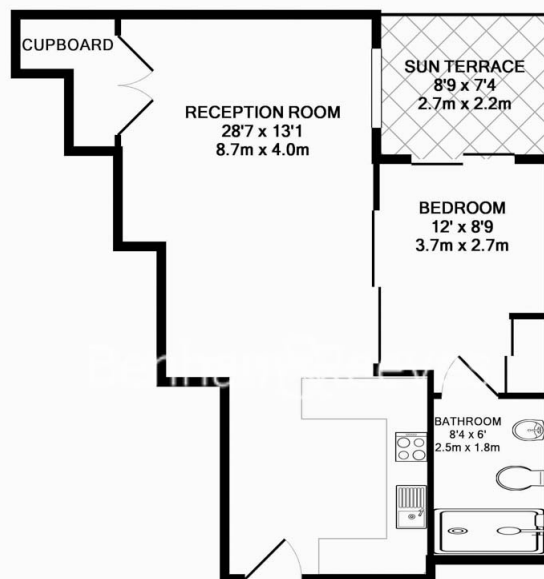

COUNTER HOUSE, IMPERIAL WHARF
TOTAL APPROX. FLOOR AREA 510 SQ.FT. (47.4 SQ.M.)

Whilst every attempt has been made to ensure the accuracy of the floor plan contained here, measurements of doors, windows, rooms and any other items are approximate and no responsibility is taken for any error, omission, or mis-statement. This plan is for illustrative purposes only and should be used as such by any prospective purchaser. The services, systems and appliances shown have not been tested and no guarantee as to their operability or efficiency can be given.
Made with Metropix ©2014

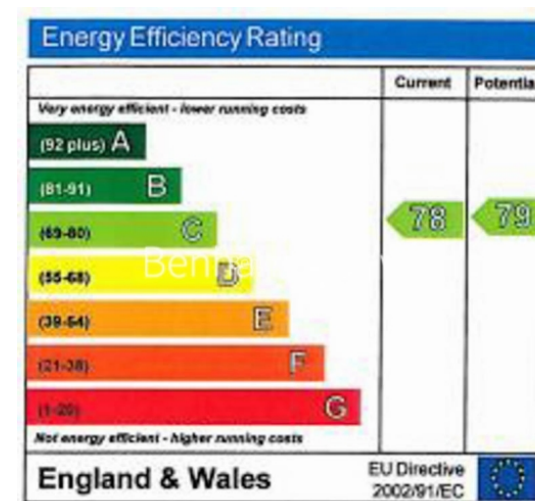

London branches open six days a week Mon - Sat

Canary Wharf | City | Colindale | Dartmouth Park | Ealing | Fulham
Hammersmith | Hampstead | Highgate | Hyde Park | Kensington | Kew
Knightsbridge | Nine Elms | Shoreditch | Southall | Surrey Quays
Wapping | Wembley | White City | Woolwich

International offices

China | Hong Kong SAR | India | Israel | Malaysia | Middle East | Pakistan
Qatar | Singapore | South Africa | Thailand | Turkey



Benham & Reeves