



Benham & Reeves

Ashburn Gardens, Gloucester Road, SW7

£750 per week, £3,250 per month + fees

 2 Bedrooms  1 Bathroom 
Furnished/UnFurnished

A Bright lower ground apartments set in a period conversion close to the amenities of South Kensington and Gloucester Road Underground Station (Circle, District and Piccadilly Line).

Please [click here](#) for full detail

Property features

2 Bedrooms | 1 Bathroom | Reception | Furnished | Fitted Kitchen | EPC-C | 1252 Sq Ft | Close to Amenities | Patio | Nearby Gloucester Road Tube Station

For more information about this property,
please call our Kensington branch on

020 7938 3522

Redress & Client Money Protection :

Benham and Reeves are members of The Property Ombudsman redress scheme and have Client Money protection with ARLA Propertymark. You can find more information on our website at <https://www.benhams.com/membership/>



Benham & Reeves



Ashburn Gardens, Gloucester Road, SW7

£750 per week, £3,250 per month + fees

www.benhams.com

Ashburn Gardens, SW7

Approximate Gross Internal Area : 66 sq m / 710 sq ft

DRAFT

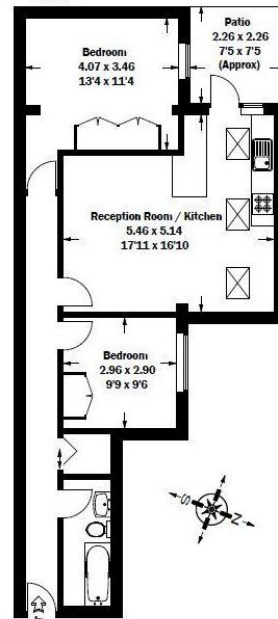

Lower Ground Floor

Illustration for Identification Purposes Only. Not to Scale.

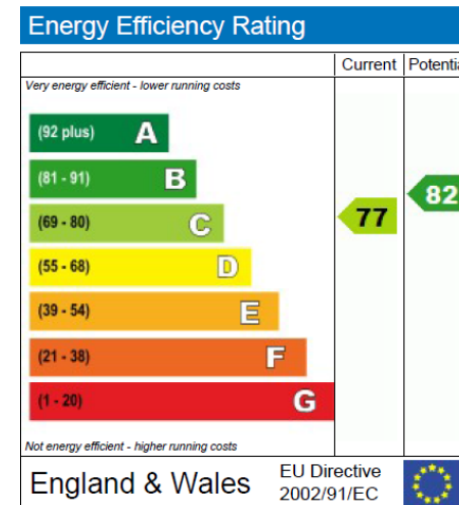

London branches open six days a week Mon - Sat

Canary Wharf | City | Colindale | Dartmouth Park | Ealing | Fulham
 Hammersmith | Hampstead | Highgate | Hyde Park | Kensington | Kew
 Knightsbridge | Nine Elms | Shoreditch | Southall | Surrey Quays
 Wapping | Wembley | White City | Woolwich

International offices

China | Hong Kong SAR | India | Indonesia | Qatar | Malaysia | Middle East |
 Singapore | South Africa | Thailand | Turkey

