



Benham & Reeves

Finchley Road, Golders Green, NW11

£1,750 per week, £7,583 per month + fees

 4 Bedrooms  3 Bathrooms  Furnished

Large, air-conditioned 1st floor apartment, with secure underground parking, situated in a coveted development a short walk from Golders green Underground station, a short walk from Golders Green Tube station (Northern line).

Please [click here](#) for full detail

Property features

4 Bedrooms | 3 Bathrooms | Reception | Furn/Unfurn | Fitted Kitchen | EPC-B | Communal Gardens | Off-Street Parking | Nearby Golders Green Tube Station

For more information about this property,
please call our Hampstead branch on

020 7435 9681

Redress & Client Money Protection :

Benham and Reeves are members of The Property Ombudsman redress scheme and have Client Money protection with ARLA Propertymark. You can find more information on our website at <https://www.benhamandreeves.com/membership/>



Benham&Reeves



Finchley Road, Golders Green, NW11

£1,750 per week, £7,583 per month + fees

www.benhams.com

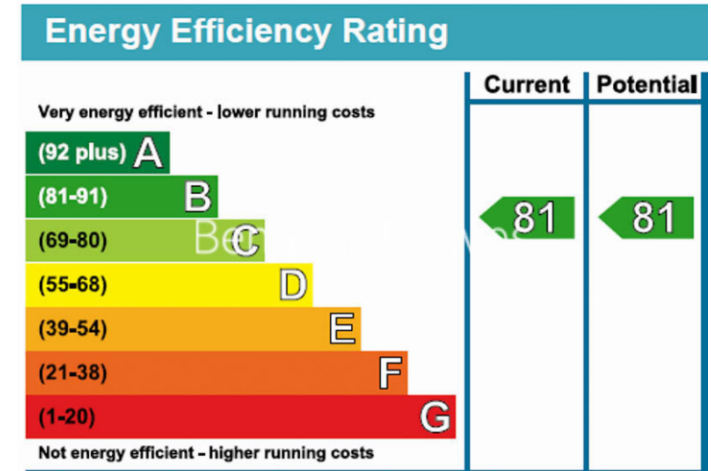
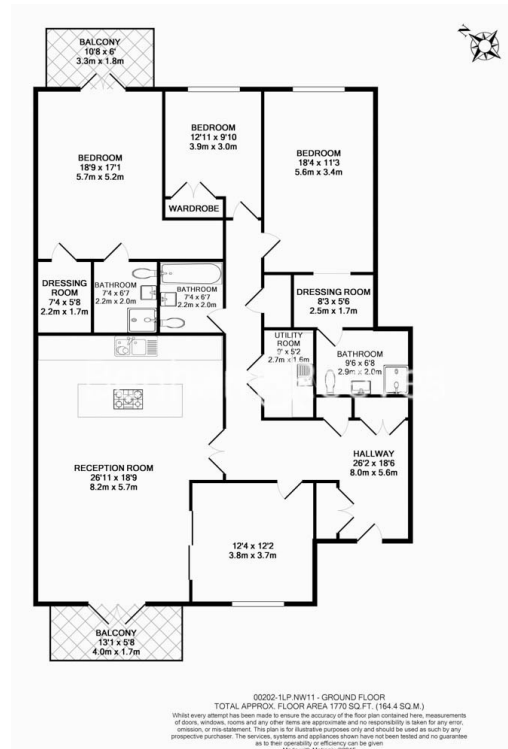

London branches open six days a week Mon - Sat

Canary Wharf | City | Colindale | Dartmouth Park | Ealing | Fulham
Hammersmith | Hampstead | Highgate | Hyde Park | Kensington | Kew
Knightsbridge | Nine Elms | Shoreditch | Southall | Surrey Quays
Wapping | Wembley | White City | Woolwich

International offices

China | Hong Kong SAR | India | Israel | Malaysia | Middle East | Pakistan
Qatar | Singapore | South Africa | Thailand | Turkey



Benham & Reeves