



Benham & Reeves

Laycock Street, Highbury & Islington, N1

£923 per week, £4,000 per month + fees

 2 Bedrooms  2 Bathrooms  Furnished

Spacious 2-bedroom and 2-bathroom apartment set over two floors. Property is offered furnished and is moments away from Highbury & Islington Station making it an ideal place for professional sharers working in the City to live.

Please [click here](#) for full detail

Property features

Spacious Two Double Bedroom Apartment | 2 Family sized Bathrooms | Open Plan Reception | Fully Fitted Kitchen | Furnished | EPC-B | Daily porter | Private Balcony | Excellent Transport links Nearby | Highbury & Islington Station Moments Away

For more information about this property,
please call our City branch on

020 7213 9700



Redress & Client Money Protection :

Benham and Reeves are members of The Property Ombudsman redress scheme and have Client Money protection with ARLA Propertymark. You can find more information on our website at <https://www.benhams.com/membership/>

Benham & Reeves

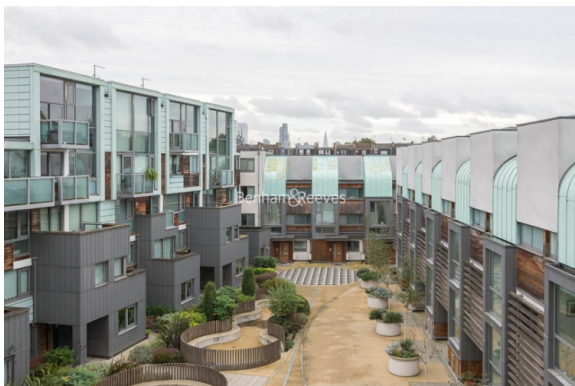

Laycock Street, Highbury & Islington, N1

£923 per week, £4,000 per month + fees

www.benhams.com

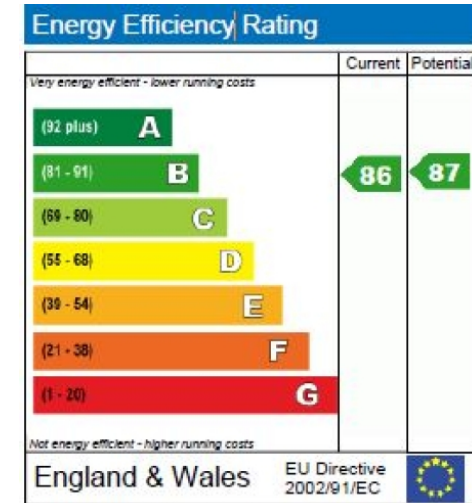

London branches open six days a week Mon - Sat

Canary Wharf | City | Colindale | Dartmouth Park | Ealing | Fulham
Hammersmith | Hampstead | Highgate | Hyde Park | Kensington | Kew
Knightsbridge | Nine Elms | Shoreditch | Southall | Surrey Quays
Wapping | Wembley | White City | Woolwich

International offices

China | Hong Kong SAR | India | Israel | Malaysia | Middle East | Pakistan
Qatar | Singapore | South Africa | Thailand | Turkey

