



Benham & Reeves

GoldHurst House, Hammersmith, W6

£2,250 per week, £9,750 per month + fees

 3 Bedrooms  3 Bathrooms  Unfurnished

Luxurious 2nd floor apartment with direct River Views, and a range of residents' onsite amenities located in an exclusive Riverside development in the heart of Hammersmith. Well-located for Hammersmith Broadway and the Underground station (Circle, District, Piccadilly, and Hammersmith and City lines).

Please [click here](#) for full detail

Property features

3 Bedrooms | 3 Bathrooms | Reception | Unfurnished | Fitted Kitchen | EPC-B | 1900 Sq Ft | Gym, Swimming Pool and Spa | Car Parking | Nearby Hammersmith Tube Station

For more information about this property, please call our Hammersmith branch on

020 8600 0960

Redress & Client Money Protection :

Benham and Reeves are members of The Property Ombudsman redress scheme and have Client Money protection with ARLA Propertymark. You can find more information on our website at <https://www.benhamandreeves.com/membership/>



Benham & Reeves



GoldHurst House, Hammersmith, W6

£2,250 per week, £9,750 per month + fees

www.benhams.com

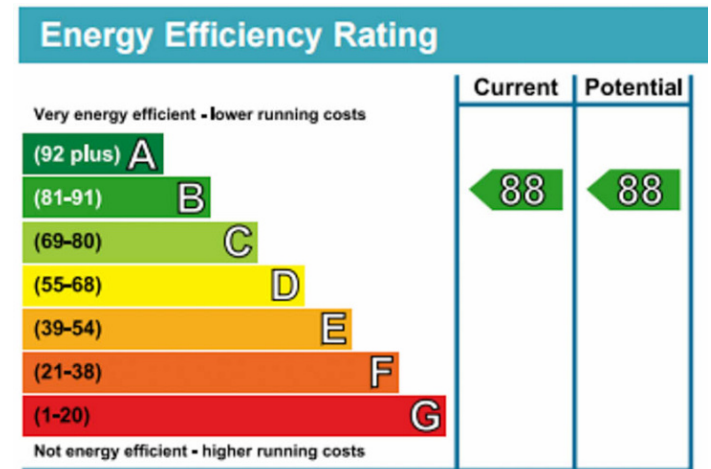
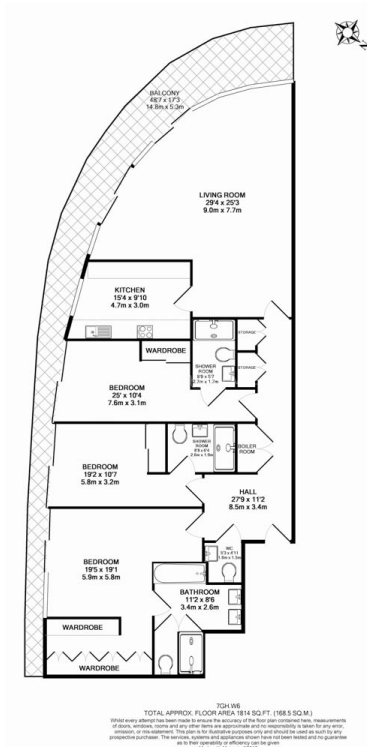

London branches open six days a week Mon - Sat

Canary Wharf | City | Colindale | Dartmouth Park | Ealing | Fulham
Hammersmith | Hampstead | Highgate | Hyde Park | Kensington | Kew
Knightsbridge | Nine Elms | Shoreditch | Southall | Surrey Quays
Wapping | Wembley | White City | Woolwich

International offices

China | Hong Kong SAR | India | Indonesia | Qatar | Malaysia | Middle East | Pakistan
Singapore | South Africa | Thailand | Turkey



Benham & Reeves