



Benham & Reeves

## **Lisburne Road, Hampstead, NW3**

£589 per week, £2,552 per month + fees

 2 Bedrooms    2 Bathrooms    Unfurnished

A delightfully bright and charming ground floor garden within an attractive red brick period terraced house located on a quiet residential street in Hampstead.

Please [click here](#) for full detail

## Property features

**2 Bedrooms | Walk-in Shower to Bedroom 2 | Private South-East Facing Garden | Ensuite Bathroom to Bedroom 1 | Double Aspect Stone-Floor Reception Room | EPC-D | Under Floor Heating | Guest WC | Nearby Belsize Park Underground Station**

For more information about this property,  
please call our Hampstead branch on

**020 7435 9681**

Redress & Client Money Protection :

Benham and Reeves are members of The Property Ombudsman redress scheme and have Client Money protection with ARLA Propertymark. You can find more information on our website at <https://www.benham.com/membership/>



Benham&Reeves





# Lisburne Road, Hampstead, NW3

£589 per week, £2,552 per month + fees

[www.benhams.com](http://www.benhams.com)

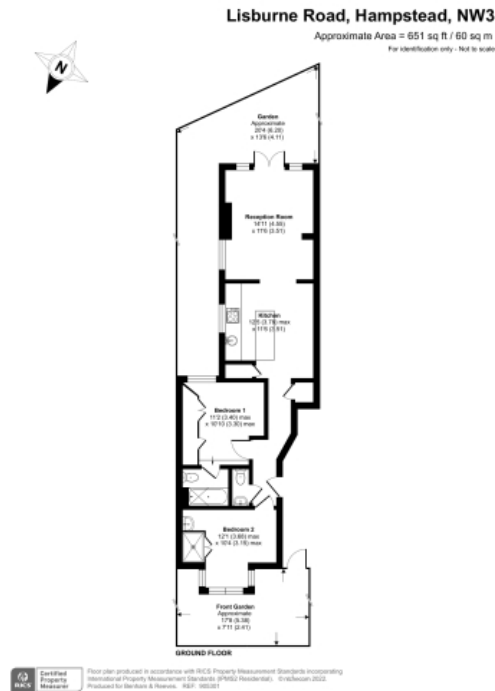

Score	Energy rating	Current	Potential
92+	A		
81-91	B		
69-80	C		70   C
55-68	D	59   D	
39-54	E		
21-38	F		
1-20	G		

## London branches open six days a week Mon - Sat

Canary Wharf | City | Colindale | Dartmouth Park | Ealing | Fulham  
Hammersmith | Hampstead | Highgate | Hyde Park | Kensington | Kew  
Knightsbridge | Nine Elms | Shoreditch | Southall | Surrey Quays  
Wapping | Wembley | White City | Woolwich

## International offices

China | Hong Kong SAR | India | Indonesia | Qatar | Malaysia | Middle East | Pakistan  
Singapore | South Africa | Thailand | Turkey

