



Benham & Reeves

## **King Henrys Road, Hampstead, NW3**

£1,384 per week, £5,997 per month + fees

 3 Bedrooms    3 Bathrooms     
Furnished/UnFurnished

Spectacular, large ground floor garden apartment set in a beautiful Victorian conversion, private entrance, two off street parking spaces and Primrose Hill zone residents' parking. A short walk from Swiss Cottage Station.

Please [click here](#) for full detail

## Property features

**3 Double Bedrooms | 3 Bathrooms (2 En-Suite) | Reception Room | Furn/Unfurn | Fitted Kitchen | EPC-D | Jacuzzi and Alarm | Private Garden, Conservatory | Off Street Parking | Swiss Cottage station**

For more information about this property,  
please call our Hampstead branch on

**020 7435 9681**

Redress & Client Money Protection :

Benham and Reeves are members of The Property Ombudsman redress scheme and have Client Money protection with ARLA Propertymark. You can find more information on our website at <https://www.benhamandreeves.com/membership/>



Benham&Reeves





# King Henrys Road, Hampstead, NW3

£1,384 per week, £5,997 per month + fees

www.benhams.com

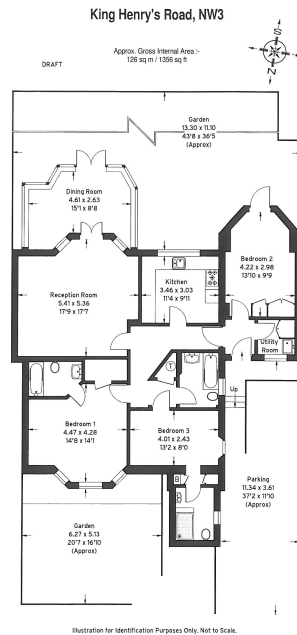

Score	Energy rating	Current	Potential
92+	A		
81-91	B		
69-80	C		74   C
55-68	D	66   D	
39-54	E		
21-38	F		
1-20	G		

## London branches open six days a week Mon - Sat

Canary Wharf | City | Colindale | Dartmouth Park | Ealing | Fulham  
Hammersmith | Hampstead | Highgate | Hyde Park | Kensington | Kew  
Knightsbridge | Nine Elms | Shoreditch | Southall | Surrey Quays  
Wapping | Wembley | White City | Woolwich

## International offices

China | Hong Kong SAR | India | Indonesia | Qatar | Malaysia | Middle East | Pakistan  
Singapore | South Africa | Thailand | Turkey



Benham & Reeves