



Benham & Reeves

Regency Lodge, Hampstead, NW3

£542 per week, £2,350 per month + fees

 1 Bedroom  1 Bathroom  Furnished

A spacious top-floor apartment, with separate study room, situated within a sought-after Mansion block in Swiss Cottage, moments from the Tube Station. Cottage tube station.

Please [click here](#) for full detail

Property features

Large Double Bedroom Apartment | Generous Reception Room | Seperate Kitchen | Excellent Fitted Storage | Extra study area | EPC- E | Heating and Hot Water Included in Rent | Secure Portered Mansion Block | Excellent Location to Local Amenities | Swiss Cottage Underground Station is Walking Distance

For more information about this property,
please call our Hampstead branch on

020 7435 9681



Redress & Client Money Protection :
Benham and Reeves are members of The Property Ombudsman redress scheme and have Client Money protection with ARLA Propertymark.
You can find more information on our website at <https://www.benhams.com/membership/>

Benham & Reeves



Regency Lodge, Hampstead, NW3

£542 per week, £2,350 per month + fees

www.benhams.com

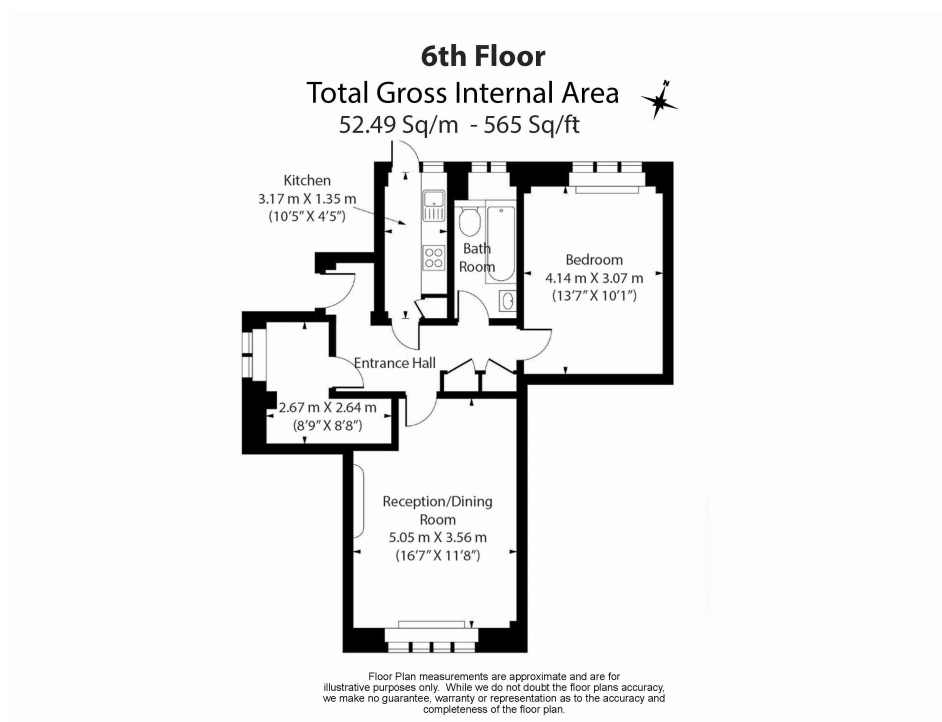

Score	Energy rating	Current	Potential
92+	A		
81-91	B		
69-80	C		74 C
55-68	D		
39-54	E	50 E	
21-38	F		
1-20	G		

London branches open six days a week Mon - Sat

Canary Wharf | City | Colindale | Dartmouth Park | Ealing | Fulham
Hammersmith | Hampstead | Highgate | Hyde Park | Kensington | Kew
Knightsbridge | Nine Elms | Shoreditch | Southall | Surrey Quays
Wapping | Wembley | White City | Woolwich

International offices

China | Hong Kong SAR | India | Indonesia | Qatar | Malaysia | Middle East | Pakistan
Singapore | South Africa | Thailand | Turkey



Benham & Reeves