



Benham & Reeves

## **Hornby Close, Hampstead ,NW3**

£1,327 per week, £5,750 per month + fees

 5 Bedrooms    3 Bathrooms    Unfurnished

A stunning, large, recently renovated 3 story townhouse, with private patio garden and private permit parking in this exclusive residential square just steps from Swiss Cottage Underground Station.

Please [click here](#) for full detail

## Property features

**A spacious 1743sqft 3 storey-townhouse located | 5 bedrooms 3 bathrooms, spacious 588sqft lounge on the 1st | Exceptionally large kitchen dining with all integrated | Spacious private rear patio garden, access from kitchen | Recently fully renovated in 2021 | EPC-C | Modern bathrooms with a spacious bathtub and 2 walk-in showers | Plenty of natural lights from all windows facing to both | Private permit parking available for the residents | Easy access to Swiss Cottage underground station**

For more information about this property,  
please call our Hampstead branch on

**020 7435 9681**



Redress & Client Money Protection :

Benham and Reeves are members of The Property Ombudsman redress scheme and have Client Money protection with ARLA Propertymark. You can find more information on our website at <https://www.benhams.com/membership/>

**Benham & Reeves**





# Hornby Close, Hampstead ,NW3

£1,327 per week, £5,750 per month + fees

www.benhams.com

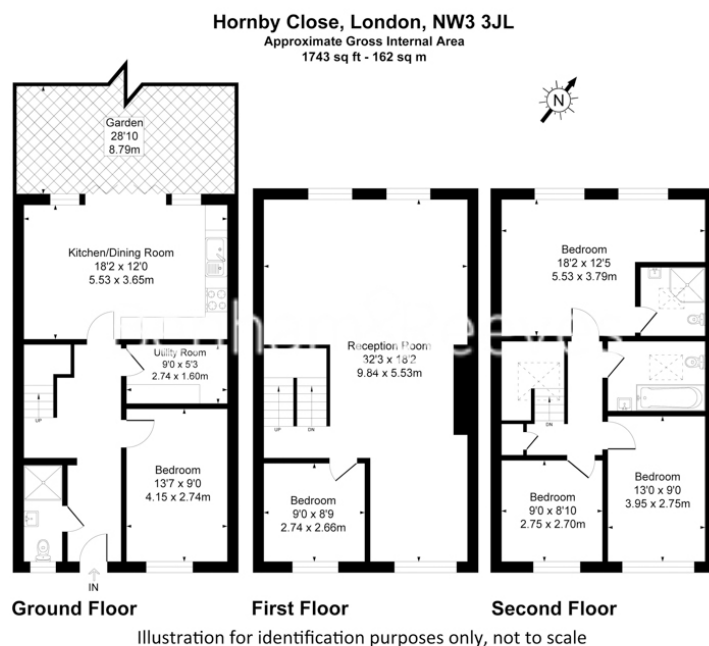

Score	Energy rating	Current	Potential
92+	A		
81-91	B		81 B
69-80	C	72 C	
55-68	D		
39-54	E		
21-38	F		
1-20	G		

## London branches open six days a week Mon - Sat

Canary Wharf | City | Colindale | Dartmouth Park | Ealing | Fulham  
Hammersmith | Hampstead | Highgate | Hyde Park | Kensington | Kew  
Knightsbridge | Nine Elms | Shoreditch | Southall | Surrey Quays  
Wapping | Wembley | White City | Woolwich

## International offices

China | Hong Kong SAR | India | Indonesia | Qatar | Malaysia | Middle East | Pakistan  
Singapore | South Africa | Thailand | Turkey



Benham & Reeves