



Benham & Reeves

Hansel Road, Hampstead, NW6

£439 per week, £1,902 per month + fees

 1 Bedroom  1 Bathroom  Furnished

Smart modern second floor apartment with terrace situated in an attractive purpose-built block in Maida Vale. Nearby Kilburn Park Station (Bakerloo).

Please [click here](#) for full detail

Property features

1 Bedroom | 1 Bathroom | Open Plan Reception | Furnished | Kitchen | EPC-C | Terrace | Underfloor Heating | Nearby Kilburn Park Station (Bakerloo)

For more information about this property,
please call our Hampstead branch on

020 7435 9681





Hansel Road, Hampstead, NW6

£439 per week, £1,902 per month + fees

www.benhams.com

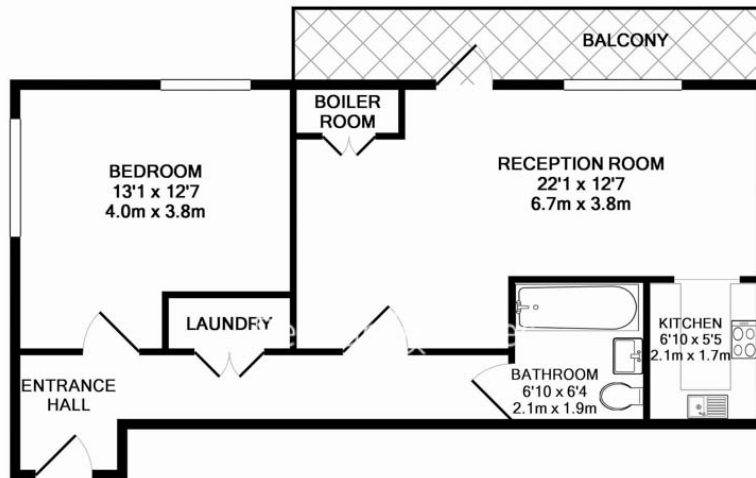

F8.CH.1HR.NW6
TOTAL APPROX. FLOOR AREA 576 SQ.FT. (53.5 SQ.M.)

Whilst every attempt has been made to ensure the accuracy of the floor plan contained here, measurements of doors, windows, rooms and any other items are approximate and no responsibility is taken for any error, omission, or mis-statement. This plan is for illustrative purposes only and should be used as such by any prospective purchaser. The services, systems and appliances shown have not been tested and no guarantee as to their operability or efficiency can be given
Made with Metropix ©2017

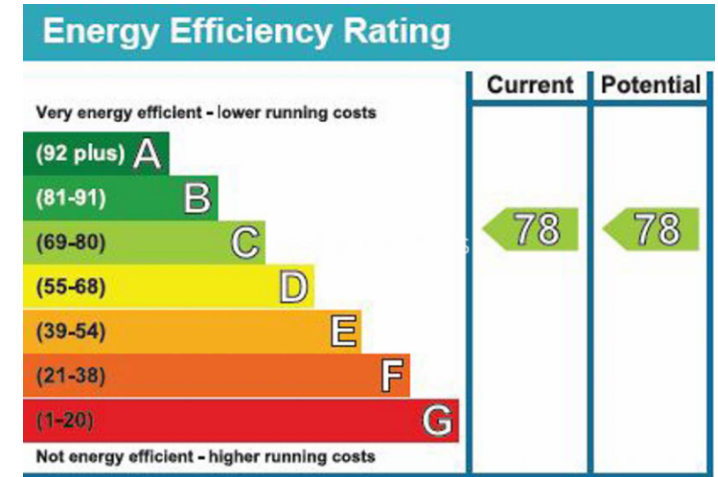

London branches open six days a week Mon - Sat

Canary Wharf | City | Colindale | Dartmouth Park | Ealing | Fulham
Hammersmith | Hampstead | Highgate | Hyde Park | Kensington | Kew
Knightsbridge | Nine Elms | Shoreditch | Southall | Surrey Quays
Wapping | Wembley | White City | Woolwich

International offices

China | Hong Kong SAR | India | Indonesia | Qatar | Malaysia | Middle East |
Singapore | South Africa | Thailand | Turkey

