



Benham & Reeves

Henshaw Parade, Hampstead, NW9

£415 per week, £1,799 per month + fees

 1 Bedroom  1 Bathroom  Furnished

Stylish 5th floor apartment, with impressive skyline views, situated in a new development in Hendon, with excellent transport links nearby

Please [click here](#) for full detail

Property features

Bright open-plan kitchen and reception area with high-quality | Private balcony - ideal for relaxing or entertaining | Spacious double bedroom with built-in storage | Contemporary bathroom finished to a high standard | 24-hour concierge service | EPC-B | Fully equipped on-site gym | Private cinema room | Landscaped communal gardens | Excellent transport links into Central London

For more information about this property,
please call our Hampstead branch on

020 7435 9681

Redress & Client Money Protection :

Benham and Reeves are members of The Property Ombudsman redress scheme and have Client Money protection with ARLA Propertymark. You can find more information on our website at <https://www.benhamandreeves.com/membership/>



Benham & Reeves



Henshaw Parade, Hampstead, NW9

£415 per week, £1,799 per month + fees

www.benhams.com

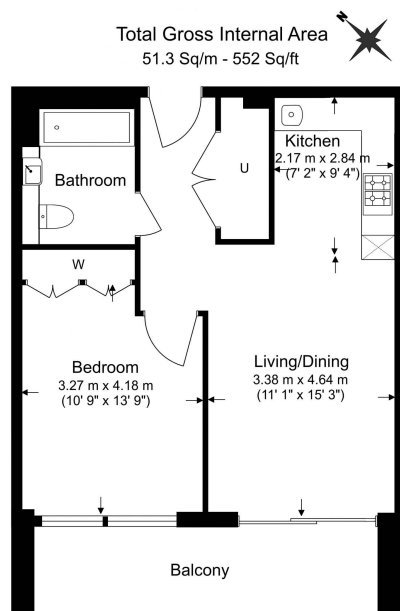

Benham & Reeves

Floor Plan measurements are approximate and are for illustrative purposes only. While we do not doubt the floor plans accuracy, we make no guarantee, warranty or representation as to the accuracy and completeness of the floor plan.

Score	Energy rating	Current	Potential
92+	A		
81-91	B	81 B	81 B
69-80	C		
55-68	D		
39-54	E		
21-38	F		
1-20	G		

London branches open six days a week Mon - Sat

Canary Wharf | City | Colindale | Dartmouth Park | Ealing | Fulham
Hammersmith | Hampstead | Highgate | Hyde Park | Kensington | Kew
Knightsbridge | Nine Elms | Shoreditch | Southall | Surrey Quays
Wapping | Wembley | White City | Woolwich

International offices

China | Hong Kong SAR | India | Indonesia | Qatar | Malaysia | Middle East | Pakistan
Singapore | South Africa | Thailand | Turkey



Benham & Reeves