



Benham & Reeves

Farine Avenue, Hayes, UB3

£381 per week, £1,651 per month + fees

 1 Bedroom  1 Bathroom  Furnished

2nd floor apartment situated in an exciting development in Hayes, close to Hayes and Harlington Station, a strategic stop on the new superfast Elizabeth Line connecting to Central London, Canary Wharf and Heathrow Airport.

Please [click here](#) for full detail

Property features

One Bedroom Apartment | Balcony | Residents Gym | Furnished | Wood Floors | EPC-B | Modern Kitchen | Close to Amenities | Hayes and Harlington Station

For more information about this property,
please call our Southall branch on

020 8051 0800



Redress & Client Money Protection :
Benham and Reeves are members of The Property Ombudsman redress scheme and have Client Money protection with ARLA Propertymark.
You can find more information on our website at <https://www.benhams.com/membership/>

Benham & Reeves



Farine Avenue, Hayes, UB3

£381 per week, £1,651 per month + fees

www.benhams.com

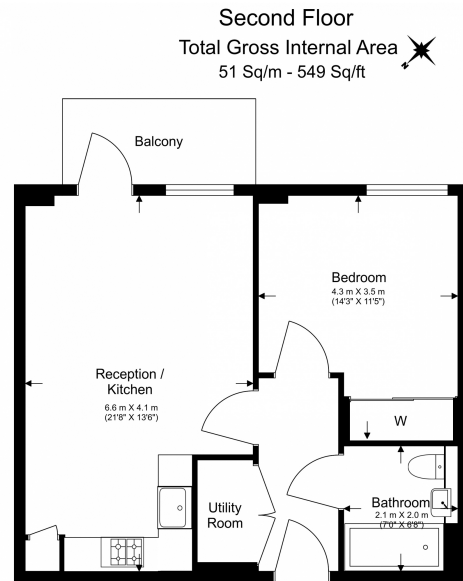

Floor Plan measurements are approximate and are for illustrative purposes only. While we do not doubt the floor plans accuracy, we make no guarantee, warranty or representation as to the accuracy and completeness of the floor plan.

Score	Energy rating	Current	Potential
92+	A		
81-91	B	85 B	85 B
69-80	C		
55-68	D		
39-54	E		
21-38	F		
1-20	G		

London branches open six days a week Mon - Sat

Canary Wharf | City | Colindale | Dartmouth Park | Ealing | Fulham
Hammersmith | Hampstead | Highgate | Hyde Park | Kensington | Kew
Knightsbridge | Nine Elms | Shoreditch | Southall | Surrey Quays
Wapping | Wembley | White City | Woolwich

International offices

China | Hong Kong SAR | India | Israel | Malaysia | Middle East | Pakistan
Qatar | Singapore | South Africa | Thailand | Turkey



Benham & Reeves