



Benham & Reeves

Palomino Close, Hayes, UB4

£277 per week, £1,200 per month + fees

 1 Bedroom  1 Bathroom  Unfurnished

Well presented ground floor apartment, with access to a shared South facing garden, within walking distance to Kingshill Shopping Parade, and transport links for Northolt Station, Uxbridge, Southall, Ealing, Heathrow and Hayes Town (Elizabeth line Underground Station with Padding in under 20 minutes).

Please [click here](#) for full detail

Property features

1 Bedroom | 1 Bathroom | Unfurnished | Modern | Communal garden | EPC-B | 374 square feet (approx.) | South Facing Garden | Built In Wardrobes | Nearby Elizabeth line underground station

For more information about this property,
please call our Southall branch on

020 8051 0800

Redress & Client Money Protection :

Benham and Reeves are members of The Property Ombudsman redress scheme and have Client Money protection with ARLA Propertymark. You can find more information on our website at <https://www.benhams.com/membership/>



Benham&Reeves



Palomino Close, Hayes, UB4

£277 per week, £1,200 per month + fees

www.benhams.com

Total Gross Internal Area
34.8 Sq/m - 374 Sq/ft

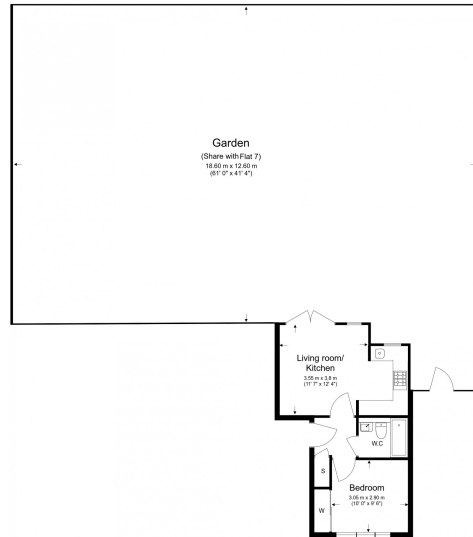

Floor Plan measurements are approximate and are for illustrative purposes only. While we do not doubt the floor plans accuracy, we make no guarantee, warranty or representation as to the accuracy and completeness of the floor plan.

Score	Energy rating	Current	Potential
92+	A		
81-91	B	81 B	81 B
69-80	C		
55-68	D		
39-54	E		
21-38	F		
1-20	G		

London branches open six days a week Mon - Sat

Canary Wharf | City | Colindale | Dartmouth Park | Ealing | Fulham
Hammersmith | Hampstead | Highgate | Hyde Park | Kensington | Kew
Knightsbridge | Nine Elms | Shoreditch | Southall | Surrey Quays
Wapping | Wembley | White City | Woolwich

International offices

China | Hong Kong SAR | India | Indonesia | Qatar | Malaysia | Middle East | Pakistan
Singapore | South Africa | Thailand | Turkey



Benham & Reeves