



Benham & Reeves

Drummond Way, Highbury and Islington, N1

£670 per week, £2,903 per month + fees

 2 Bedrooms  2 Bathrooms  Furnished

A spacious apartment set within a converted Victorian school development, moments from the amenities of Angel and Islington. The property is within walking distance from Highbury & Islington (Victoria) underground and Overground station. Parking Space available at separate negotiation.

Please [click here](#) for full detail

Property features

2 Double Bedrooms | Insert Bathroom(s) (i.e. 1 Bathroom or Bathroom(s) | Open Plan Reception | Fully Fitted Modern Kitchen | Furnished | EPC-D | 24Hr Concierge, Secured and Gated | Communal Gardens | Nearby Angel and Highbury and Islington Stations

For more information about this property,
please call our Highgate branch on

020 8341 2335



Redress & Client Money Protection :

Benham and Reeves are members of The Property Ombudsman redress scheme and have Client Money protection with ARLA Propertymark. You can find more information on our website at <https://www.benhams.com/membership/>

Benham & Reeves



Drummond Way, Highbury and Islington, N1

£670 per week, £2,903 per month + fees

www.benhams.com

2nd Floor

Approx gross internal area: 972sq/ft - 90sq/m

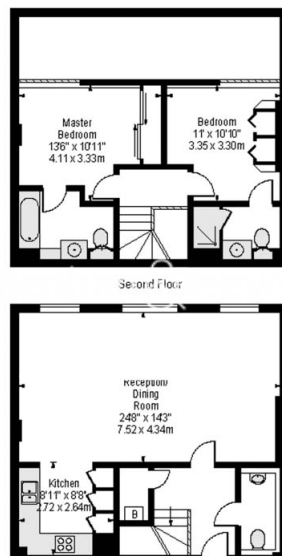

Whilst every attempt has been made to ensure the accuracy of the floor plan contained here, measurements of doors, windows, rooms and any other items are approximate and no responsibility is taken for any error, omission, or mis-statement. This plan is for illustrative purposes only and should be used as such by any prospective purchaser. The services, systems and appliances shown have not been tested and no guarantee as to their operability or efficiency can be given.
Made with Metropix ©2016

Energy Efficiency Rating		
	Current	Potential
Very energy efficient - lower running costs		
(92-plus) A		
(81-91) B		
(69-80) C		
(55-68) D	56	56
(39-54) E		
(21-38) F		
(1-20) G		
Not energy efficient - higher running costs		
England & Wales		EU Directive 2002/91/EC

London branches open six days a week Mon - Sat

Canary Wharf | City | Colindale | Dartmouth Park | Ealing | Fulham
Hammersmith | Hampstead | Highgate | Hyde Park | Kensington | Kew
Knightsbridge | Nine Elms | Shoreditch | Southall | Surrey Quays
Wapping | Wembley | White City | Woolwich

International offices

China | Hong Kong SAR | India | Israel | Malaysia | Middle East | Pakistan
Qatar | Singapore | South Africa | Thailand | Turkey



Benham & Reeves