



Benham&Reeves

Claremont Road, Highgate, N6

£900 per week, £3,900 per month + fees

 4 Bedrooms  2 Bathrooms  Unfurnished

A bright, large family Victorian mid-terrace house in excellent condition near Highgate tube station. The property is in a desirable location and features a well-maintained South facing garden
Close to Highgate Tube Station (Northern Line).

Please [click here](#) for full detail

Property features

4 Double Bedrooms | 1 Large Double Reception Room | Kitchen with Dining Area | 2 Stylish Bathrooms | Unfurnished | EPC-E | Private Garden | South Facing Garden | Nearby Highgate Station

For more information about this property,
please call our Highgate branch on

020 8341 2335

Redress & Client Money Protection :

Benham and Reeves are members of The Property Ombudsman redress scheme and have Client Money protection with ARLA Propertymark.
You can find more information on our website at <https://www.benhamandreeves.com/membership/>



Benham&Reeves



Claremont Road, Highgate, N6

£900 per week, £3,900 per month + fees

www.benhams.com

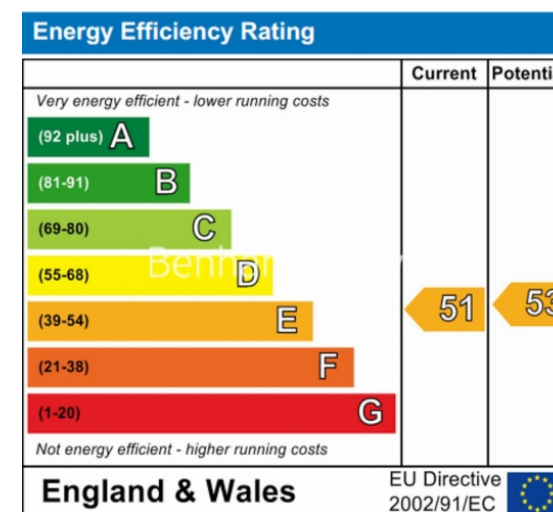
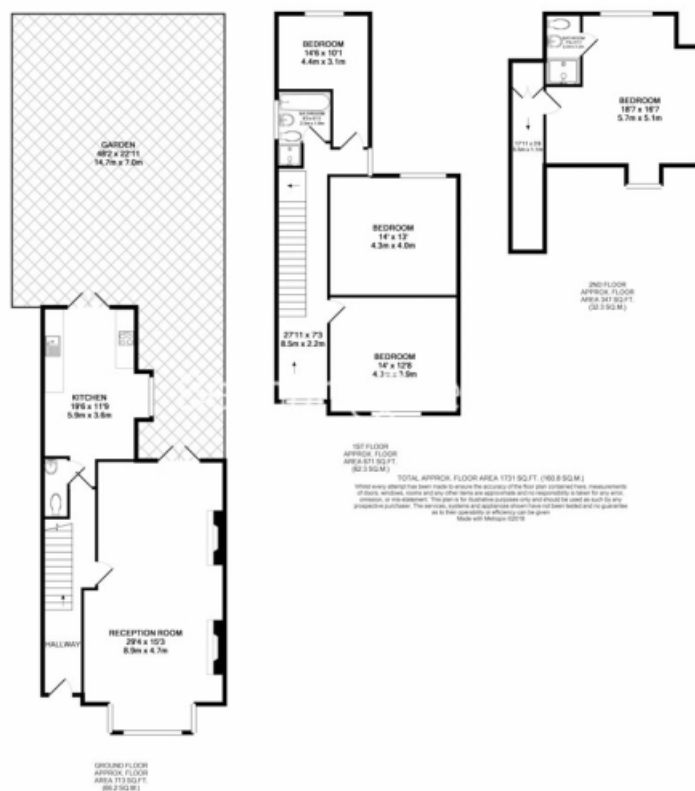

London branches open six days a week Mon - Sat

Canary Wharf | City | Colindale | Dartmouth Park | Ealing | Fulham
Hammersmith | Hampstead | Highgate | Hyde Park | Kensington | Kew
Knightsbridge | Nine Elms | Shoreditch | Southall | Surrey Quays
Wapping | Wembley | White City | Woolwich

International offices

China | Hong Kong SAR | India | Indonesia | Qatar | Malaysia | Middle East | Pakistan
Singapore | South Africa | Thailand | Turkey



Benham & Reeves