



Benham & Reeves

Priory Gardens, Highgate, N6

£1,350 per week, £5,850 per month + fees

 5 Bedrooms  2 Bathrooms  Unfurnished

Large, recently decorated, bright and light family home, with private garden and on-street parking, located on a desirable quiet road, within walking distance from Highgate tube station EPC-D

Please [click here](#) for full detail

Property features

5 Bedrooms | 2 Shower Rooms | 2 Reception Rooms | Private Garden | 2 Balconies | EPC-D | Residential Permit On Street Parking | Newly Decorated | Excellent Location | Walking distance to Highgate tube station

For more information about this property,
please call our Highgate branch on

020 8341 2335

Redress & Client Money Protection :

Benham and Reeves are members of The Property Ombudsman redress scheme and have Client Money protection with ARLA Propertymark. You can find more information on our website at <https://www.benham.com/membership/>



Benham & Reeves



Priory Gardens, Highgate, N6

£1,350 per week, £5,850 per month + fees

www.benhams.com

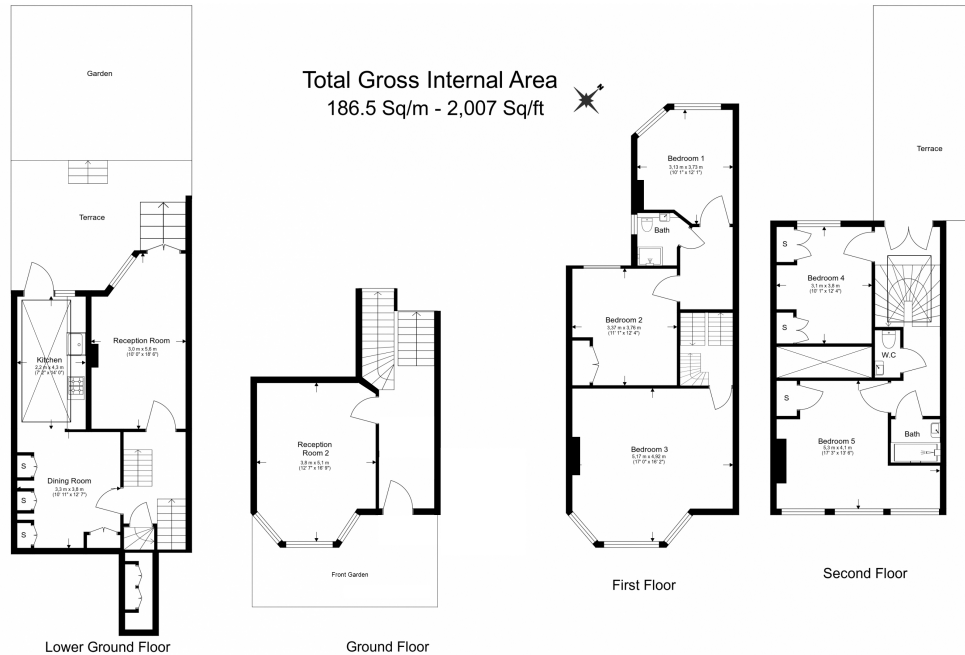

Floor Plan measurements are approximate and are for illustrative purposes only. While we do not doubt the floor plans accuracy, we make no guarantee, warranty or representation as to the accuracy and completeness of the floor plan.

Score	Energy rating	Current	Potential
92+	A		
81-91	B		83 B
69-80	C		
55-68	D	68 D	
39-54	E		
21-38	F		
1-20	G		

London branches open six days a week Mon - Sat

Canary Wharf | City | Colindale | Dartmouth Park | Ealing | Fulham
Hammersmith | Hampstead | Highgate | Hyde Park | Kensington | Kew
Knightsbridge | Nine Elms | Shoreditch | Southall | Surrey Quays
Wapping | Wembley | White City | Woolwich

International offices

China | Hong Kong SAR | India | Indonesia | Qatar | Malaysia | Middle East |
Singapore | South Africa | Thailand | Turkey

