



Benham & Reeves

Milton Avenue, Highgate, N6

£485 per week, £2,100 per month + fees

🛏️ 2 Bedrooms 🚿 1 Bathroom 🚗 Unfurnished

UNFURNISHED.

Newly decorated, bright and light two double bedroom flat in the ever popular Miltons area, Highgate N6.

Please [click here](#) for full detail

Property features

Two Bedrooms | One Bathroom | Semi Open Plan Kitchen/Reception Room | Quiet Residential Road | Newly Decorated | EPC- D | South After Highgate Location | Unfurnished | Residential Permit Parking Available On The Street | Walking Distance To Highgate Tube And Other Transport Links

For more information about this property,
please call our Highgate branch on

020 8341 2335

Redress & Client Money Protection :

Benham and Reeves are members of The Property Ombudsman redress scheme and have Client Money protection with ARLA Propertymark. You can find more information on our website at <https://www.benhams.com/membership/>



Benham & Reeves



Milton Avenue, Highgate, N6

£485 per week, £2,100 per month + fees

www.benhams.com

Total Gross Internal Area
58 Sq/m - 624.3 Sq/ft

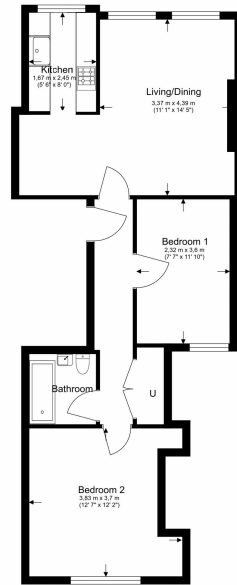

Benham & Reeves

Floor Plan measurements are approximate and are for illustrative purposes only. While we do not doubt the floor plans accuracy, we make no guarantee, warranty or representation as to the accuracy and completeness of the floor plan.

London branches open six days a week Mon - Sat

Canary Wharf | City | Colindale | Dartmouth Park | Ealing | Fulham
Hammersmith | Hampstead | Highgate | Hyde Park | Kensington | Kew
Knightsbridge | Nine Elms | Shoreditch | Southall | Surrey Quays
Wapping | Wembley | White City | Woolwich

International offices

China | Hong Kong SAR | India | Indonesia | Qatar | Malaysia | Middle East |
Singapore | South Africa | Thailand | Turkey



Benham & Reeves