



Benham & Reeves

Habito, Hounslow, TW3

£438 per week, £1,898 per month + fees

 2 Bedrooms  2 Bathrooms  Unfurnished

Dual aspect spacious apartment situated in a boutique development in the heart of Hounslow, TW3. Just a few minutes from Hounslow central underground (Piccadilly Line) which offers access to both the West End and Heathrow.

Please [click here](#) for full detail

Property features

Two Private Balconies | Modern Aspect | Wood Floors | Central Heating | Double Storage | EPC-B | Communal Gardens | Local Amenities | Lift Access | Hounslow Central

For more information about this property,
please call our Kew branch on

020 8326 1960



Redress & Client Money Protection :
Benham and Reeves are members of The Property Ombudsman redress scheme and have Client Money protection with ARLA Propertymark.
You can find more information on our website at <https://www.benhamandreeves.com/membership/>

Benham & Reeves



Habito, Hounslow, TW3

£438 per week, £1,898 per month + fees

www.benhams.com

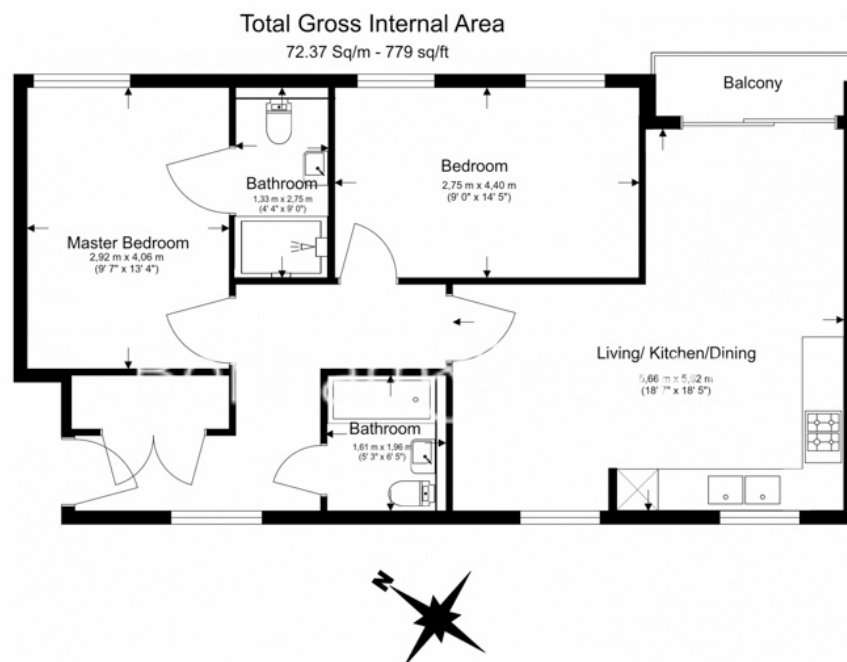

Floor Plan measurements are approximate and are for illustrative purposes only. While we do not doubt the floor plans accuracy, we make no guarantee, warranty or representation as to the accuracy and completeness of the floor plan.

Energy Efficiency Rating

Very energy efficient - lower running costs

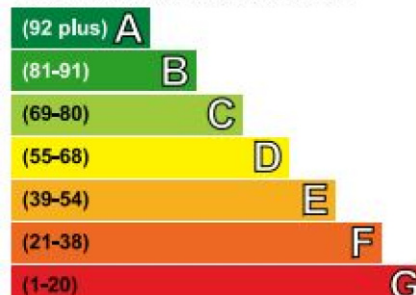

Current	Potential
83	83

Not energy efficient - higher running costs

London branches open six days a week Mon - Sat

Canary Wharf | City | Colindale | Dartmouth Park | Ealing | Fulham
Hammersmith | Hampstead | Highgate | Hyde Park | Kensington | Kew
Knightsbridge | Nine Elms | Shoreditch | Southall | Surrey Quays
Wapping | Wembley | White City | Woolwich

International offices

China | Hong Kong SAR | India | Indonesia | Qatar | Malaysia | Middle East | Pakistan
Singapore | South Africa | Thailand | Turkey



Benham&Reeves