



Benham & Reeves

Eastfields Avenue, Imperial Wharf, SW18

£670 per week, £2,903 per month + fees

 2 Bedrooms  2 Bathrooms  Furnished

A bright and spacious apartment set within a Riverside development overlooking Fulham's famous Hurlingham Club, close to Putney and Wandsworth Park. Parking is available by separate negotiation. EPC-B

Please [click here](#) for full detail

Property features

2 Bedrooms | 2 Bathrooms | Reception | Furnished | Fitted Kitchen | EPC-B | 24 Hour Concierge | Residents Gym & Swimming Pool | Nearby Wandsworth Station

For more information about this property,
please call our Fulham branch on

020 7348 7620

Redress & Client Money Protection :

Benham and Reeves are members of The Property Ombudsman redress scheme and have Client Money protection with ARLA Propertymark. You can find more information on our website at <https://www.benhamandreeves.com/membership/>



Benham & Reeves



Eastfields Avenue, Imperial Wharf, SW18

£670 per week, £2,903 per month + fees

www.benhams.com

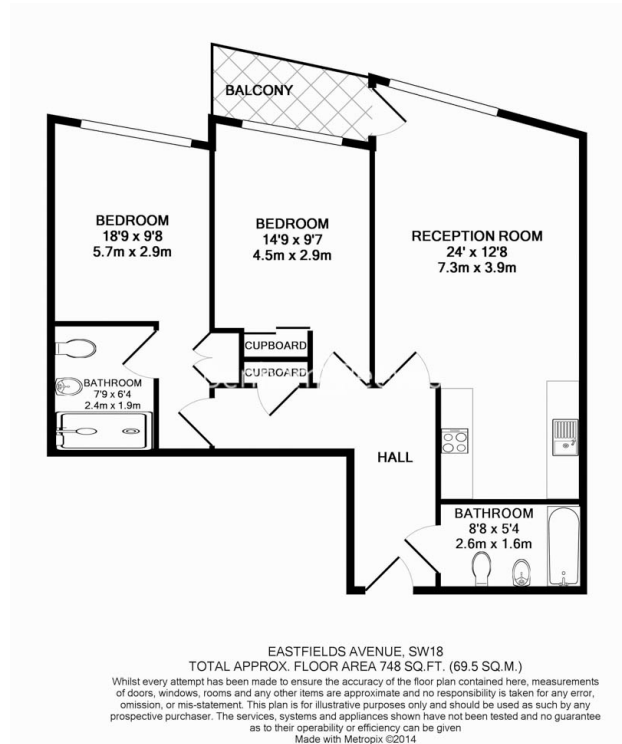

Energy Efficiency Rating

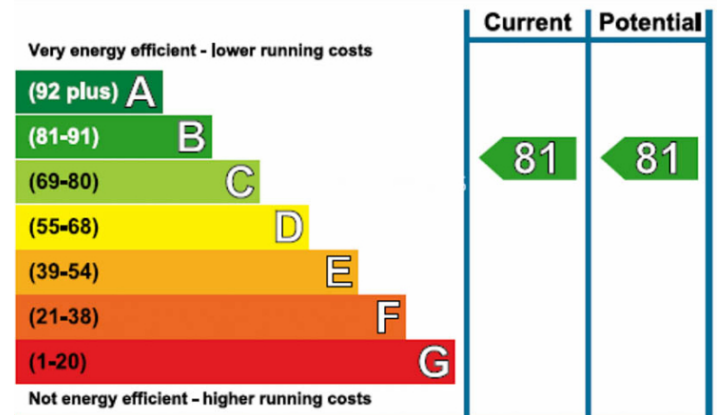

London branches open six days a week Mon - Sat

Canary Wharf | City | Colindale | Dartmouth Park | Ealing | Fulham
Hammersmith | Hampstead | Highgate | Hyde Park | Kensington | Kew
Knightsbridge | Nine Elms | Shoreditch | Southall | Surrey Quays
Wapping | Wembley | White City | Woolwich

International offices

China | Hong Kong SAR | India | Indonesia | Qatar | Malaysia | Middle East |
Singapore | South Africa | Thailand | Turkey



Benham & Reeves