



Benham&Reeves

## **Townmead Road, Imperial Wharf, SW6**

£542 per week, £2,350 per month + fees

 1 Bedroom    1 Bathroom    Furnished

A stylish apartment, with underground parking, set within a desirable Landmark riverside development, with good transport connections via Imperial Wharf Overground Station.

Please [click here](#) for full detail

## Property features

**1 Bedroom | 1 Bathroom | Reception | Furnished | Fitted Kitchen | EPC-B | 24 Hour Concierge | Lifts to all floors | Nearby Imperial Wharf Overground**

For more information about this property,  
please call our Fulham branch on

**020 7348 7620**

Redress & Client Money Protection :

Benham and Reeves are members of The Property Ombudsman redress scheme and have Client Money protection with ARLA Propertymark. You can find more information on our website at <https://www.benhamandreeves.com/membership/>



Benham & Reeves

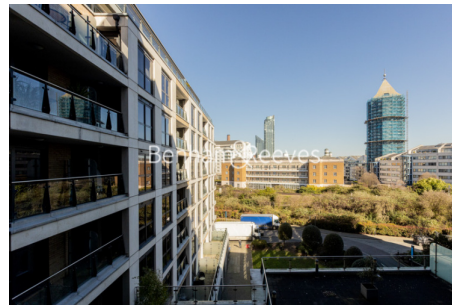



# Townmead Road, Imperial Wharf, SW6

£542 per week, £2,350 per month + fees

[www.benhams.com](http://www.benhams.com)

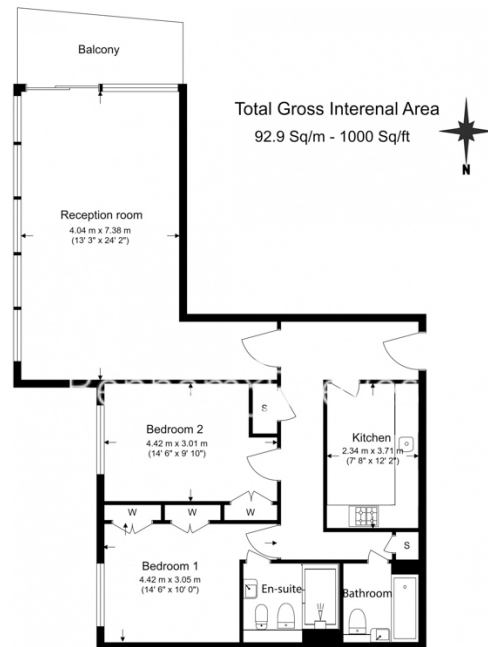

Benham & Reeves

Floor Plan measurements are approximate and are for illustrative purposes only. While we do not doubt the floor plans accuracy, we make no guarantee, warranty or representation as to the accuracy and completeness of the floor plan.

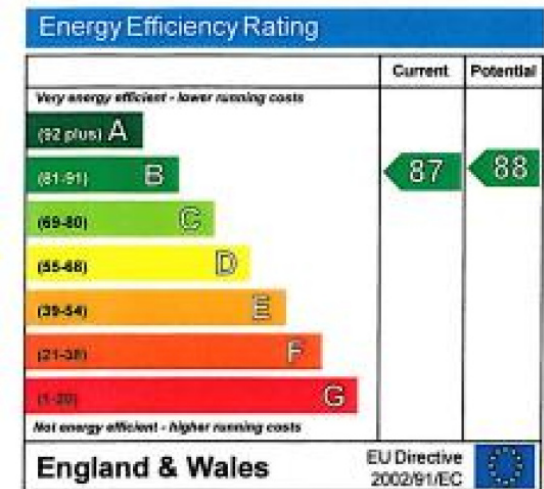

## London branches open six days a week Mon - Sat

Canary Wharf | City | Colindale | Dartmouth Park | Ealing | Fulham  
Hammersmith | Hampstead | Highgate | Hyde Park | Kensington | Kew  
Knightsbridge | Nine Elms | Shoreditch | Southall | Surrey Quays  
Wapping | Wembley | White City | Woolwich

## International offices

China | Hong Kong SAR | India | Indonesia | Qatar | Malaysia | Middle East | Pakistan  
Singapore | South Africa | Thailand | Turkey



Benham & Reeves