



Benham & Reeves

Harbour Reach, Imperial Wharf, SW6

£692 per week, £2,999 per month + fees

 2 Bedrooms  2 Bathrooms  Unfurnished

A modern 2nd floor apartment situated in a popular Riverside development, close to the amenities of Fulham and Chelsea. Ideally located to Imperial Wharf Overground Station.

Please [click here](#) for full detail

Property features

**2 Bedrooms | 2 Bathrooms | Reception | Unfurnished | Fitted kitchen | EPC-D | 24 Hour Concierge
| Fitness Centre | Nearby Imperial Wharf Station**

For more information about this property,
please call our Fulham branch on

020 7348 7620



Redress & Client Money Protection :
Benham and Reeves are members of The Property Ombudsman redress scheme and have Client Money protection with ARLA Propertymark.
You can find more information on our website at <https://www.benhams.com/membership/>

Benham & Reeves



Harbour Reach, Imperial Wharf, SW6

£692 per week, £2,999 per month + fees

www.benhams.com

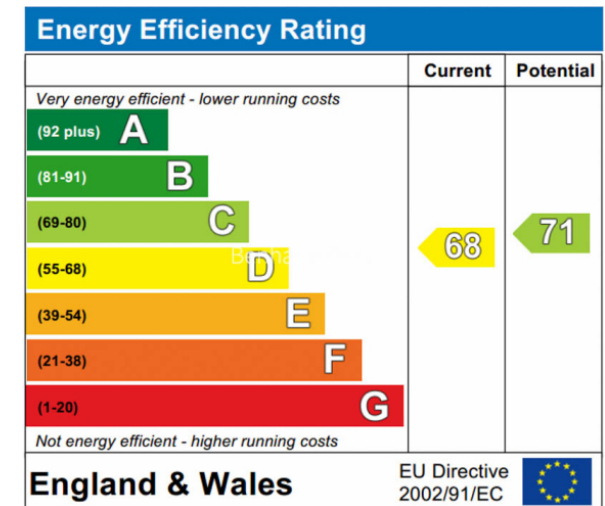
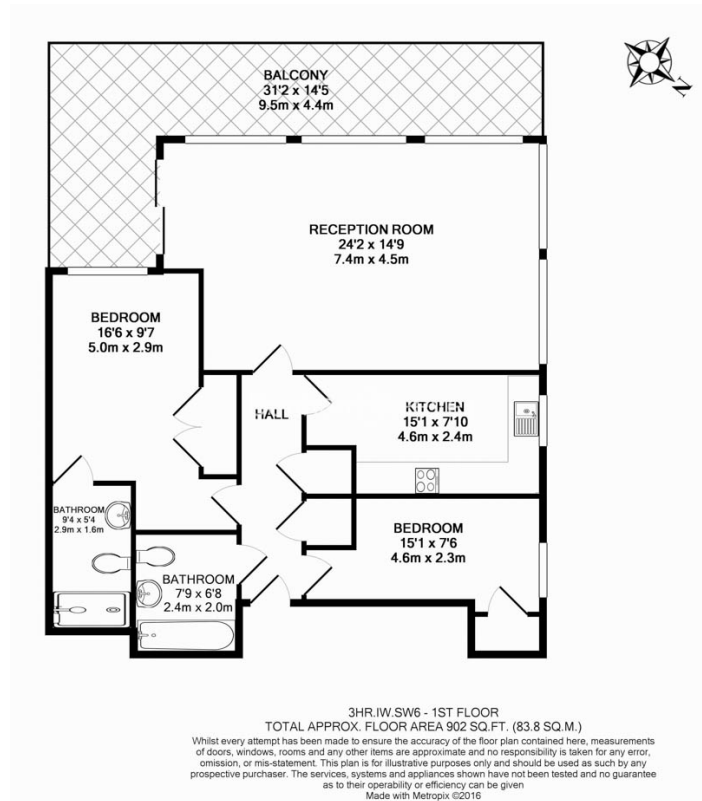

London branches open six days a week Mon - Sat

Canary Wharf | City | Colindale | Dartmouth Park | Ealing | Fulham
 Hammersmith | Hampstead | Highgate | Hyde Park | Kensington | Kew
 Knightsbridge | Nine Elms | Shoreditch | Southall | Surrey Quays
 Wapping | Wembley | White City | Woolwich

International offices

China | Hong Kong SAR | India | Indonesia | Qatar | Malaysia | Middle East |
 Singapore | South Africa | Thailand | Turkey



Benham & Reeves