



Benham & Reeves

## Harbour Reach, Imperial Wharf, SW6

£600 per week, £2,600 per month + fees

🚪 2 Bedrooms    🚿 2 Bathrooms    🛋️ Unfurnished

Modern 4th floor apartment in a landmark development with a very large reception room with dining area and access to a balcony. Added benefits include comfort cooling, 24 hour portering and lifts to all floors. EPC-C

Please [click here](#) for full detail

## Property features

**2 Bedroom | 2 Bathrooms | Reception | Furnished | Fitted Kitchen | EPC-C | Gym Facilities | Comfort Cooling 24 hour Concierge | Fulham Broadway Underground Station**

For more information about this property,  
please call our Fulham branch on

**020 7348 7620**

Redress & Client Money Protection :

Benham and Reeves are members of The Property Ombudsman redress scheme and have Client Money protection with ARLA Propertymark. You can find more information on our website at <https://www.benhamandreeves.com/membership/>



**Benham & Reeves**





# Harbour Reach, Imperial Wharf, SW6

£600 per week, £2,600 per month + fees

[www.benhams.com](http://www.benhams.com)

Total Gross Internal Area  
63.11 Sq/m - 679 Sq/ft

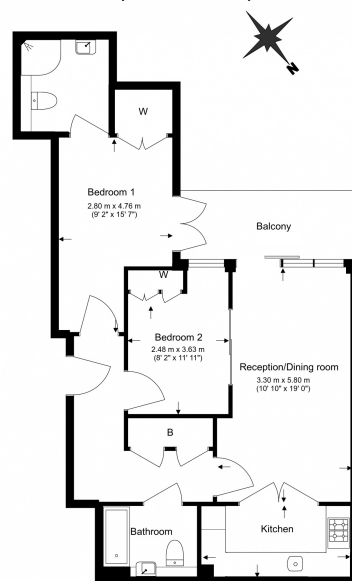

Floor Plan measurements are approximate and are for illustrative purposes only. While we do not doubt the floor plans accuracy, we make no guarantee, warranty or representation as to the accuracy and completeness of the floor plan.

## Energy Efficiency Rating

Very energy efficient - lower running costs

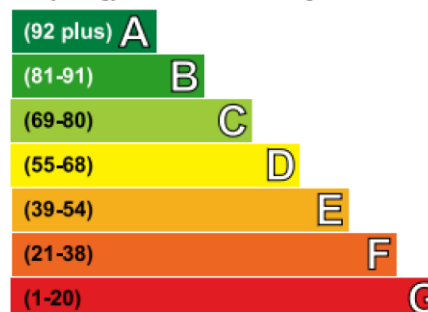

Current	Potential
80	83

Not energy efficient - higher running costs

## London branches open six days a week Mon - Sat

Canary Wharf | City | Colindale | Dartmouth Park | Ealing | Fulham  
Hammersmith | Hampstead | Highgate | Hyde Park | Kensington | Kew  
Knightsbridge | Nine Elms | Shoreditch | Southall | Surrey Quays  
Wapping | Wembley | White City | Woolwich

## International offices

China | Hong Kong SAR | India | Indonesia | Qatar | Malaysia | Middle East | Pakistan  
Singapore | South Africa | Thailand | Turkey



Benham & Reeves