



Benham & Reeves

The Boulevard, Imperial Wharf, SW6

£1,038 per week, £4,500 per month + fees

 3 Bedrooms  3 Bathrooms  Furnished

A smart and spacious 2nd floor apartment, with lift access, situated in an impressive riverside development in Fulham, moments from Imperial Wharf Overground Station.

Please [click here](#) for full detail

Property features

3 Double bedrooms | Renovated to a high luxury standard | 3 Modernised bathrooms | Fully furnished | Direct River views | EPC- B | 24-hour concierge | Residents' gym | On-site shops and restaurants | Secure parking (available by separate negotiation)

For more information about this property,
please call our Fulham branch on

020 7348 7620

Redress & Client Money Protection :

Benham and Reeves are members of The Property Ombudsman redress scheme and have Client Money protection with ARLA Propertymark. You can find more information on our website at <https://www.benhamandreeves.com/membership/>



Benham & Reeves

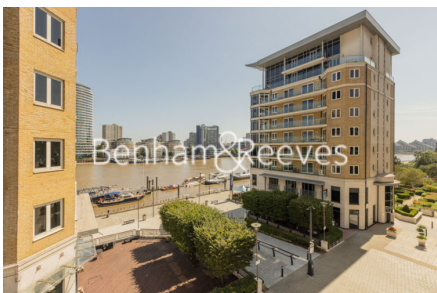

The Boulevard, Imperial Wharf, SW6

£1,038 per week, £4,500 per month + fees

www.benhams.com

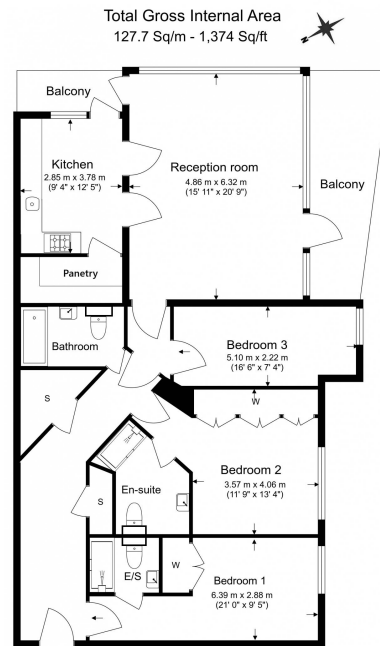

Benham & Reeves

Floor Plan measurements are approximate and are for illustrative purposes only. While we do not doubt the floor plans accuracy, we make no guarantee, warranty or representation as to the accuracy and completeness of the floor plan.

London branches open six days a week Mon - Sat

Canary Wharf | City | Colindale | Dartmouth Park | Ealing | Fulham
Hammersmith | Hampstead | Highgate | Hyde Park | Kensington | Kew
Knightsbridge | Nine Elms | Shoreditch | Southall | Surrey Quays
Wapping | Wembley | White City | Woolwich

International offices

China | Hong Kong SAR | India | Indonesia | Qatar | Malaysia | Middle East |
Singapore | South Africa | Thailand | Turkey



Benham & Reeves