



Benham & Reeves

## **Holloway Road, Islington, N7**

£625 per week, £2,708 per month + fees

 2 Bedrooms    2 Bathrooms    Part-furnished

Beautiful, bright 2nd floor apartment situated in a popular gated development in N7. Perfectly located a stone's throw from Highbury & Islington Station (Victoria Line, Overground, British Rail) and the open space of Highbury Fields.

Please [click here](#) for full detail

## Property features

**Two double bedrooms | Fully fitted modern kitchen | Two bathrooms | Open plan reception room | Juliet balcony | EPC-B | Lift | Communal garden | Secured gated development | Nearby Highbury & Islington Station**

For more information about this property, please call our Highgate branch on

**020 8341 2335**

Redress & Client Money Protection :

Benham and Reeves are members of The Property Ombudsman redress scheme and have Client Money protection with ARLA Propertymark. You can find more information on our website at <https://www.benhamandreeves.com/membership/>



Benham&Reeves



# Holloway Road, Islington, N7

£625 per week, £2,708 per month + fees

www.benhams.com

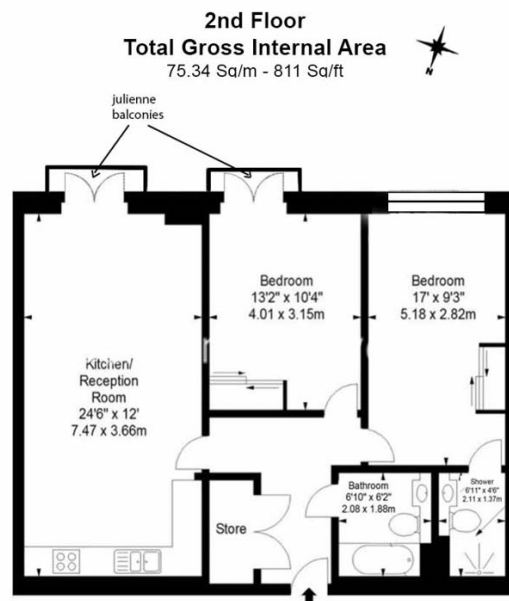

Floor Plan measurements are approximate and are for illustrative purposes only. While we do not doubt the floor plans accuracy, we make no guarantee, warranty or representation as to the accuracy and completeness of the floor plan.

Score	Energy rating	Current	Potential
92+	A		
81-91	B	85   B	85   B
69-80	C		
55-68	D		
39-54	E		
21-38	F		
1-20	G		

## London branches open six days a week Mon - Sat

Canary Wharf | City | Colindale | Dartmouth Park | Ealing | Fulham  
Hammersmith | Hampstead | Highgate | Hyde Park | Kensington | Kew  
Knightsbridge | Nine Elms | Shoreditch | Southall | Surrey Quays  
Wapping | Wembley | White City | Woolwich

## International offices

China | Hong Kong SAR | India | Indonesia | Qatar | Malaysia | Middle East | Pakistan  
Singapore | South Africa | Thailand | Turkey



Benham & Reeves