



Benham & Reeves

Benham & Reeves

**Commercial Street, Kensington, E1**

£825 per week, £3,575 per month + fees

 2 Bedrooms    2 Bathrooms    Furnished

Well-presented apartment within a modern development in Aldgate East, moments from the tube and within a short walk of The City, Spitalfields and Shoreditch

Please [click here](#) for full detail

## Property features

**Luxury 2 Bedroom Apartment | Open Plan Reception With Balcony | Fitted Kitchen With Integrated Siemens Appliances | 2 Well Equipped Double Bedrooms | Bespoke Family Size Bathroom | EPC-B | Wood Floors, LED Mood Lighting, Underfloor Heating & Comfort | 24hr Concierge, Residents Lounge, Pool, Jacuzzi, Gym & Cinem | Short Walk To The City & St Katherine Docks & Close To Spita | Moments From Tower Hill Underground & Tower Gateway DLR Stat**

For more information about this property, please call our Wapping branch on

**020 7680 8900**

Redress & Client Money Protection :

Benham and Reeves are members of The Property Ombudsman redress scheme and have Client Money protection with ARLA Propertymark. You can find more information on our website at <https://www.benhams.com/membership/>



**Benham & Reeves**



# Commercial Street, Kensington, E1

£825 per week, £3,575 per month + fees

www.benhams.com

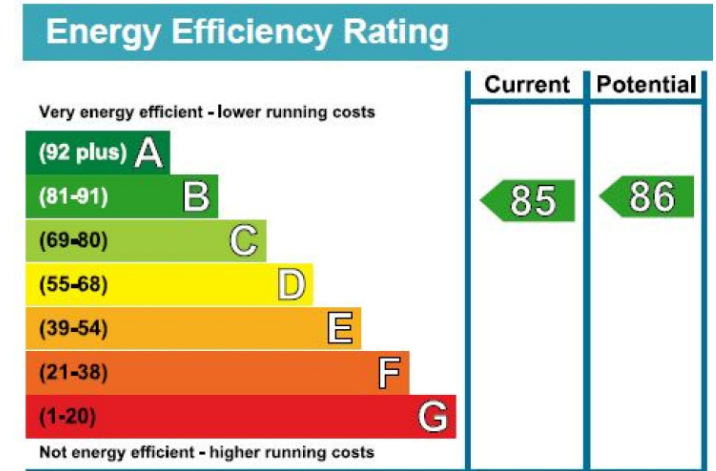
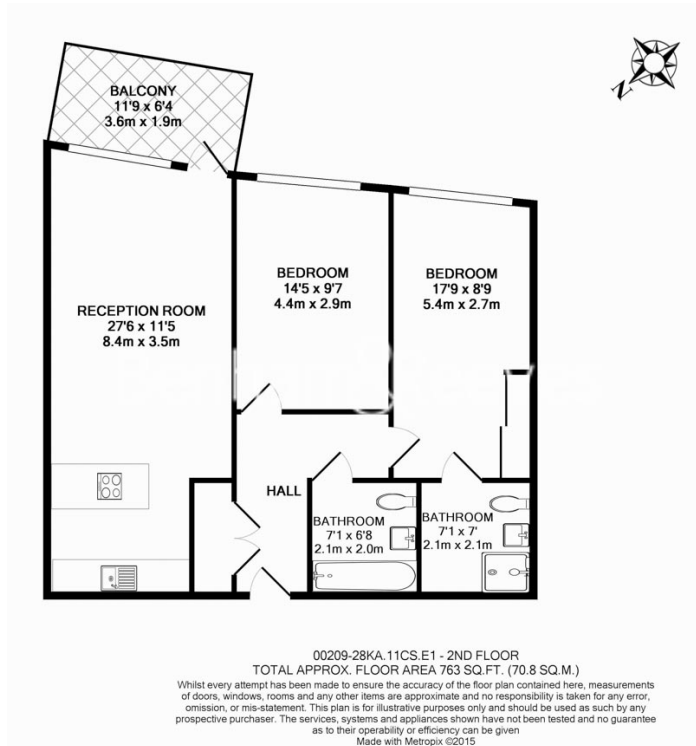

## London branches open six days a week Mon - Sat

Canary Wharf | City | Colindale | Dartmouth Park | Ealing | Fulham  
Hammersmith | Hampstead | Highgate | Hyde Park | Kensington | Kew  
Knightsbridge | Nine Elms | Shoreditch | Southall | Surrey Quays  
Wapping | Wembley | White City | Woolwich

## International offices

China | Hong Kong SAR | India | Indonesia | Qatar | Malaysia | Middle East |  
Singapore | South Africa | Thailand | Turkey

