



Benham & Reeves

Radnor Terrace, Kensington, W14

£725 per week, £3,142 per month + fees

 1 Bedroom  1 Bathroom  Furnished

A stylish 9th floor apartment, with five-star resident facilities, located in an exclusive development in Kensington. Conveniently located from Kensington Olympia Tube (District Line) and High Street Kensington Tube station.

Please [click here](#) for full detail

Property features

24 Hour Concierge | Gym, Pool and Spa | Underground Parking | Fitted Kitchen | 1 Bedroom | EPC-B | Furnished | 1 Bathroom | Nearby High Street Kensington Tube Station

For more information about this property,
please call our Kensington branch on

020 7938 3522

Redress & Client Money Protection :

Benham and Reeves are members of The Property Ombudsman redress scheme and have Client Money protection with ARLA Propertymark. You can find more information on our website at <https://www.benhamandreeves.com/membership/>



Benham & Reeves



Radnor Terrace, Kensington, W14

£725 per week, £3,142 per month + fees

www.benhams.com

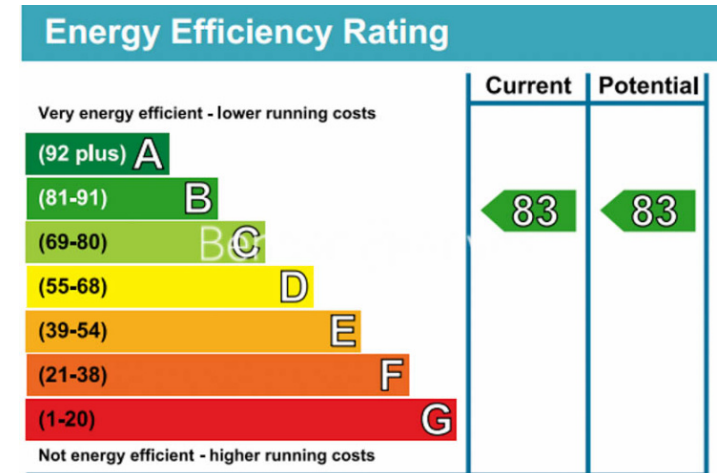
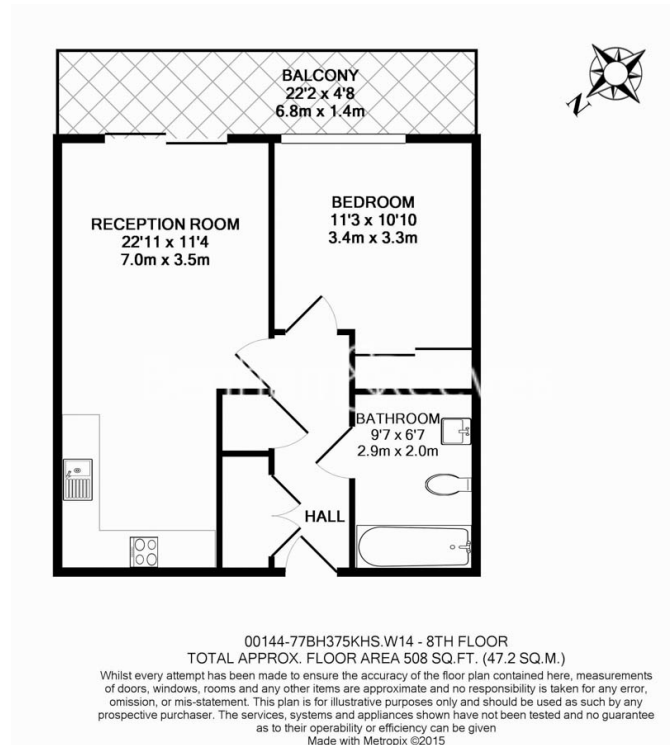

London branches open six days a week Mon - Sat

Canary Wharf | City | Colindale | Dartmouth Park | Ealing | Fulham
Hammersmith | Hampstead | Highgate | Hyde Park | Kensington | Kew
Knightsbridge | Nine Elms | Shoreditch | Southall | Surrey Quays
Wapping | Wembley | White City | Woolwich

International offices

China | Hong Kong SAR | India | Indonesia | Qatar | Malaysia | Middle East |
Singapore | South Africa | Thailand | Turkey



Benham & Reeves