



Benham & Reeves

East Acton Lane, Acton, W3

£450 per week, £1,950 per month + fees

🛏 1 Bedroom 🚿 1 Bathroom 🛋 Unfurnished

Furnished 10th floor apartment situated in an exciting development in Acton, a short walk from East Acton Station (Central Line).

Please [click here](#) for full detail

Property features

Large Open Plan Reception | Balcony | Furnished | Wood Floor | Large Windows | EPC-B | Fully Fitted Modern Kitchen | Close To Fast Transport Connections | Nearby East Acton Station

For more information about this property, please call our Ealing branch on

020 8280 0140



Redress & Client Money Protection :
Benham and Reeves are members of The Property Ombudsman redress scheme and have Client Money protection with ARLA Propertymark.
You can find more information on our website at <https://www.benhams.com/membership/>

Benham & Reeves



East Acton Lane, Acton, W3

£450 per week, £1,950 per month + fees

www.benhams.com

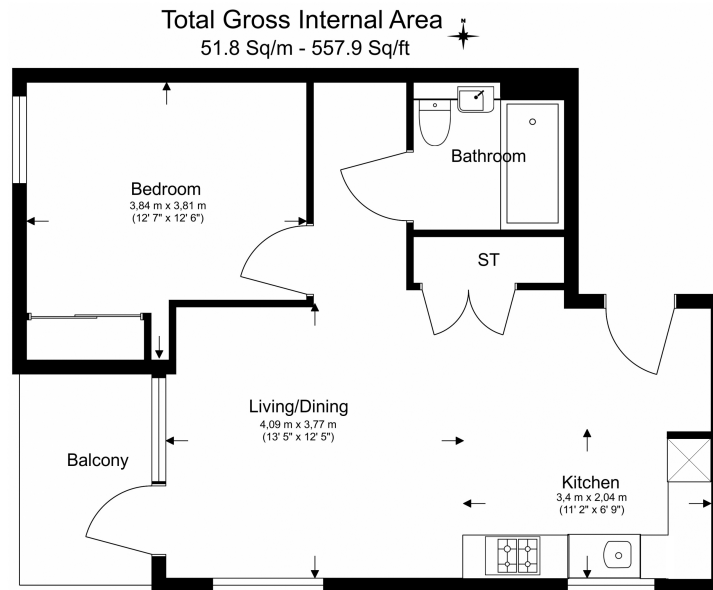

Floor Plan measurements are approximate and are for illustrative purposes only. While we do not doubt the floor plans accuracy, we make no guarantee, warranty or representation as to the accuracy and completeness of the floor plan.

Score	Energy rating	Current	Potential
92+	A		
81-91	B	83 B	83 B
69-80	C		
55-68	D		
39-54	E		
21-38	F		
1-20	G		

London branches open six days a week Mon - Sat

Canary Wharf | City | Colindale | Dartmouth Park | Ealing | Fulham
Hammersmith | Hampstead | Highgate | Hyde Park | Kensington | Kew
Knightsbridge | Nine Elms | Shoreditch | Southall | Surrey Quays
Wapping | Wembley | White City | Woolwich

International offices

China | Hong Kong SAR | India | Israel | Malaysia | Middle East | Pakistan
Qatar | Singapore | South Africa | Thailand | Turkey



Benham & Reeves