



Benham & Reeves

Kew Riverside, Kew, TW9

£692 per week, £3,000 per month + fees

 2 Bedrooms  2 Bathrooms 
Furnished/UnFurnished

Spacious ground floor apartment with large private garden situated within a desirable Riverside development within ten minutes on foot from Kew Gardens Station.

Please [click here](#) for full detail

Property features

Underground Parking | Large Private Garden | Swimming Pool | Resident's Gym | Communal Gardens | EPC-C | Built In Storage | Underfloor Heating | Ground Floor | Nearby Kew Gardens station

For more information about this property,
please call our Kew branch on

020 8326 1960

Redress & Client Money Protection :

Benham and Reeves are members of The Property Ombudsman redress scheme and have Client Money protection with ARLA Propertymark. You can find more information on our website at <https://www.benhamandreeves.com/membership/>



Benham & Reeves



Kew Riverside, Kew, TW9

£692 per week, £3,000 per month + fees

www.benhams.com

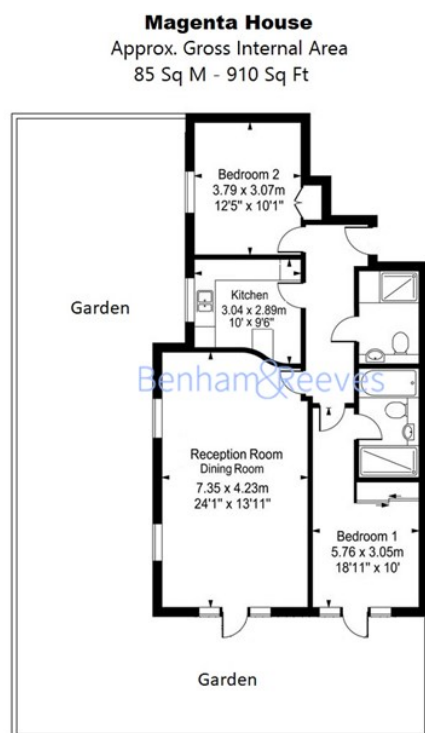

| Score | Energy rating | Current | Potential |
|-------|---------------|---------|-----------|
| 92+ | A | | |
| 81-91 | B | | |
| 69-80 | C | 74 c | 76 c |
| 55-68 | D | | |
| 39-54 | E | | |
| 21-38 | F | | |
| 1-20 | G | | |

London branches open six days a week Mon - Sat

Canary Wharf | City | Colindale | Dartmouth Park | Ealing | Fulham
Hammersmith | Hampstead | Highgate | Hyde Park | Kensington | Kew
Knightsbridge | Nine Elms | Shoreditch | Southall | Surrey Quays
Wapping | Wembley | White City | Woolwich

International offices

China | Hong Kong SAR | India | Indonesia | Qatar | Malaysia | Middle East | Pakistan
Singapore | South Africa | Thailand | Turkey



Benham & Reeves