



Benham & Reeves

Hans Crescent, Knightsbridge, SW1X

£1,350 per week, £5,850 per month + fees

🛏 2 Bedrooms 🚿 2 Bathrooms 🛏
Furnished/UnFurnished

A beautiful 929 sq ft TWO-BEDROOM apartment in a prestigious building in HANS CRESCENT, located moments away from HARRODS & SLOANE STREET. This luxurious property exemplifies contemporary style within an elegant period property in one of London's most desirable addresses.

Please [click here](#) for full detail

Property features

2 Bedrooms | 2 Bathrooms | 929 sq ft | Reception | Porter | EPC-D | Eat In Kitchen | Raised Ground Floor | Daytime Porter | Nearby Sloane Street. Knightsbridge Tube Station

For more information about this property,
please call our Knightsbridge branch on

020 7581 2112

Redress & Client Money Protection :

Benham and Reeves are members of The Property Ombudsman redress scheme and have Client Money protection with ARLA Propertymark. You can find more information on our website at <https://www.benhamandreeves.com/membership/>



Benham&Reeves



Hans Crescent, Knightsbridge, SW1X

£1,350 per week, £5,850 per month + fees

www.benhams.com

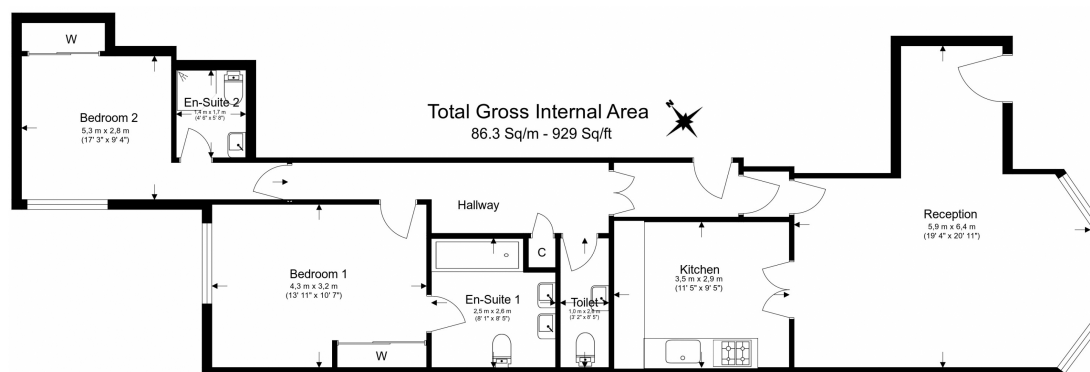

Floor Plan measurements are approximate and are for illustrative purposes only. While we do not doubt the floor plans accuracy, we make no guarantee, warranty or representation as to the accuracy and completeness of the floor plan.

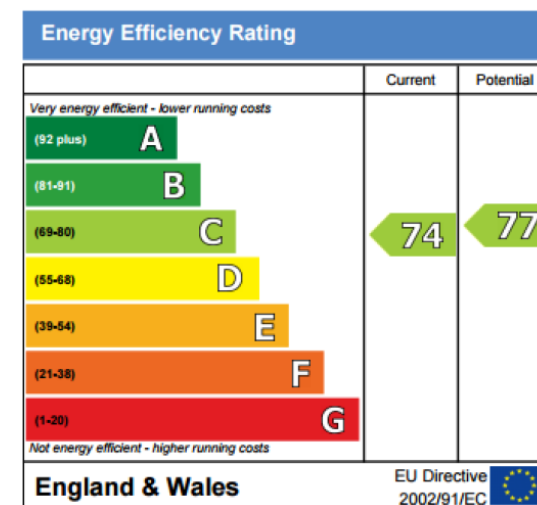

London branches open six days a week Mon - Sat

Canary Wharf | City | Colindale | Dartmouth Park | Ealing | Fulham
Hammersmith | Hampstead | Highgate | Hyde Park | Kensington | Kew
Knightsbridge | Nine Elms | Shoreditch | Southall | Surrey Quays
Wapping | Wembley | White City | Woolwich

International offices

China | Hong Kong SAR | India | Indonesia | Qatar | Malaysia | Middle East | Pakistan
Singapore | South Africa | Thailand | Turkey



Benham & Reeves