



Benham&Reeves

Egerton Gardens, Knightsbridge, SW3

£535 per week, £2,318 per month + fees

 1 Bedroom  1 Bathroom  Furnished

A delightful 343 sq ft ONE-BEDROOM flat located on EGERTON GARDENS in an elegant building with lift in the heart of KNIGHTSBRIDGE. Access to gorgeous Communal Gardens for a fee. South Kensington Station.

Please [click here](#) for full detail

Property features

Prime Knightsbridge Location | Elegant Period Building | 1 Bedroom | 1 Bathroom | Separate Modern Kitchen | EPC-E | 1st Floor | Lift | 343 sq ft | South Kensington & Knightsbridge Stations

For more information about this property,
please call our Knightsbridge branch on

020 7581 2112

Redress & Client Money Protection :

Benham and Reeves are members of The Property Ombudsman redress scheme and have Client Money protection with ARLA Propertymark. You can find more information on our website at <https://www.benhamandreeves.com/membership/>



Benham & Reeves



Egerton Gardens, Knightsbridge, SW3

£535 per week, £2,318 per month + fees

www.benhams.com

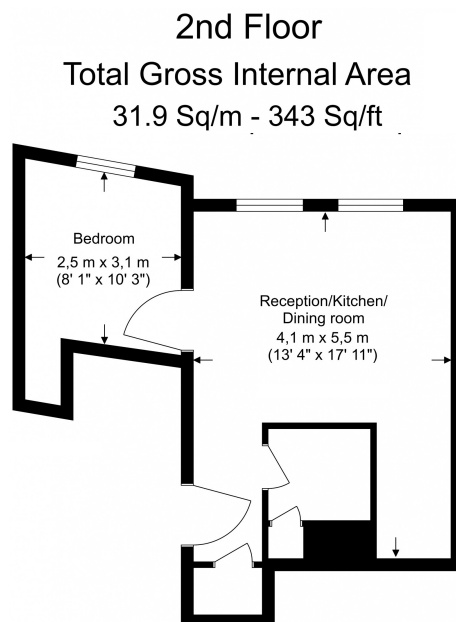

Floor Plan measurements are approximate and are for illustrative purposes only. While we do not doubt the floor plans accuracy, we make no guarantee, warranty or representation as to the accuracy and completeness of the floor plan.

Score	Energy rating	Current	Potential
92+	A		
81-91	B		
69-80	C		78 C
55-68	D		
39-54	E	53 E	
21-38	F		
1-20	G		

London branches open six days a week Mon - Sat

Canary Wharf | City | Colindale | Dartmouth Park | Ealing | Fulham
Hammersmith | Hampstead | Highgate | Hyde Park | Kensington | Kew
Knightsbridge | Nine Elms | Shoreditch | Southall | Surrey Quays
Wapping | Wembley | White City | Woolwich

International offices

China | Hong Kong SAR | India | Indonesia | Qatar | Malaysia | Middle East | Pakistan
Singapore | South Africa | Thailand | Turkey



Benham & Reeves