



Benham & Reeves

Shire House, Lamb's Passage, EC1Y

£577 per week, £2,500 per month + fees

 2 Bedrooms  1 Bathroom  Furnished

Modern, bright apartment situated within a development close to Moorgate underground and Overground stations (Northern, Circle, Metropolitan, and Hammersmith & City Lines).

Please [click here](#) for full detail

Property features

2 Bedrooms | 1 Bathroom | Large Living Space | Separate Fitted Kitchen | Furnished | EPC-C | Transport links Nearby | Excellent City Location | Breakfast bar and wood floor | Nearby Moorgate Station

For more information about this property,
please call our City branch on

020 7213 9700

Redress & Client Money Protection :

Benham and Reeves are members of The Property Ombudsman redress scheme and have Client Money protection with ARLA Propertymark. You can find more information on our website at <https://www.benhamandreeves.com/membership/>



Benham&Reeves



Shire House, Lamb's Passage, EC1Y

£577 per week, £2,500 per month + fees

www.benhams.com

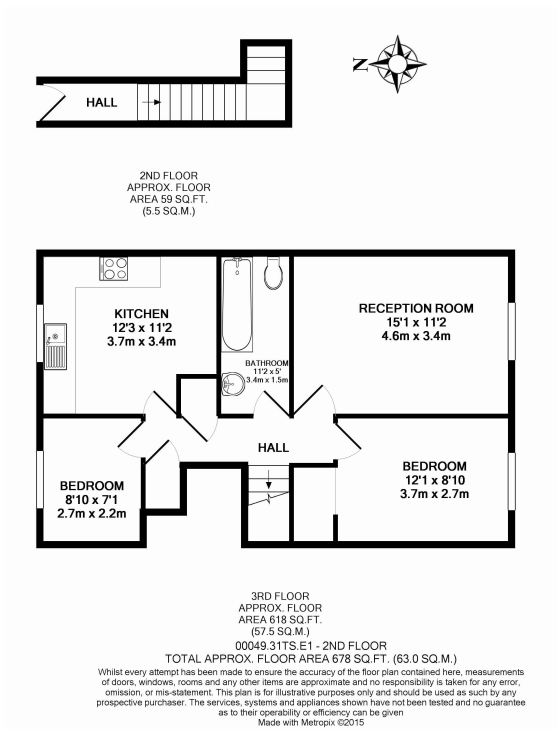

Score	Energy rating	Current	Potential
92+	A		
81-91	B		
69-80	C	78 c	80 c
55-68	D		
39-54	E		
21-38	F		
1-20	G		

London branches open six days a week Mon - Sat

Canary Wharf | City | Colindale | Dartmouth Park | Ealing | Fulham
Hammersmith | Hampstead | Highgate | Hyde Park | Kensington | Kew
Knightsbridge | Nine Elms | Shoreditch | Southall | Surrey Quays
Wapping | Wembley | White City | Woolwich

International offices

China | Hong Kong SAR | India | Indonesia | Qatar | Malaysia | Middle East |
Singapore | South Africa | Thailand | Turkey



Benham & Reeves