



Benham & Reeves

Deptford landings, London, SE8

£496 per week, £2,150 per month + fees

 2 Bedrooms  2 Bathrooms  Unfurnished

Two Bedrooms | Two Bathrooms | Unfurnished | Private Balcony | Fitted Kitchen | Open Plan | Bicycle Storage | Close to Deptford Rail & Surrey Quays Stations

Please [click here](#) for full detail

Property features

Two Bedroom | Two Bathroom | Private Balcony | Unfurnished | Fitted Kitchen | EPC-B | Open Plan | Bicycle storage | Close to Deptford rail & Surrey Quays stations

For more information about this property,
please call our Surrey Quays branch on

020 7740 3050

Redress & Client Money Protection :

Benham and Reeves are members of The Property Ombudsman redress scheme and have Client Money protection with ARLA Propertymark. You can find more information on our website at <https://www.benhams.com/membership/>



Benham&Reeves



Deptford landings, London, SE8

£496 per week, £2,150 per month + fees

www.benhams.com

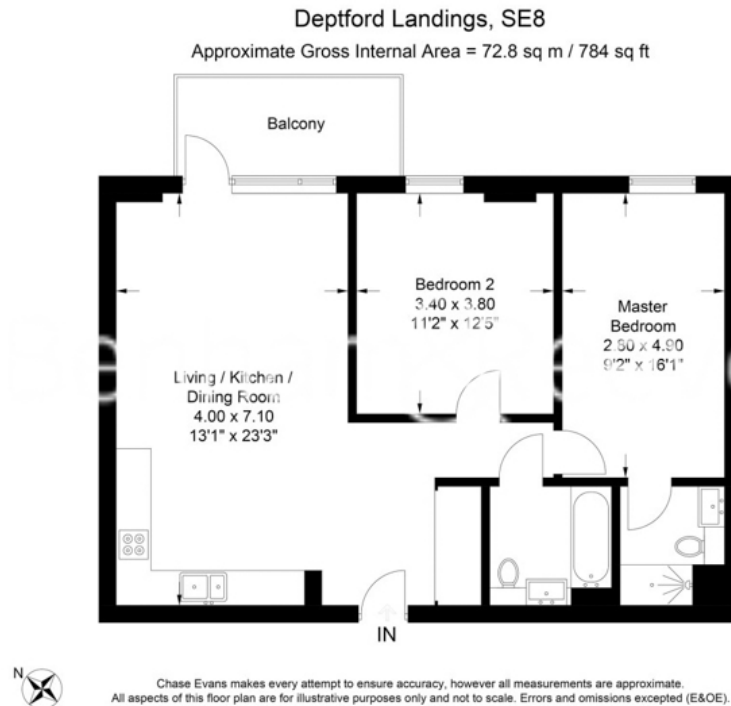

Score	Energy rating	Current	Potential
92+	A		
81-91	B	86 B	86 B
69-80	C		
55-68	D		
39-54	E		
21-38	F		
1-20	G		

London branches open six days a week Mon - Sat

Canary Wharf | City | Colindale | Dartmouth Park | Ealing | Fulham
Hammersmith | Hampstead | Highgate | Hyde Park | Kensington | Kew
Knightsbridge | Nine Elms | Shoreditch | Southall | Surrey Quays
Wapping | Wembley | White City | Woolwich

International offices

China | Hong Kong SAR | India | Indonesia | Qatar | Malaysia | Middle East | Pakistan
Singapore | South Africa | Thailand | Turkey



Benham & Reeves