



Benham & Reeves

Masefield Court, Maida Vale, W9

£762 per week, £3,302 per month + fees

 3 Bedrooms  2 Bathrooms  Unfurnished

Newly refurbished and beautifully presented 2nd floor apartment, with private parking, situated in sought after Maida Vale, moments from Paddington Recreation Ground and the scenic banks and boats of Little Venice. A short walk to good transport links.

Please [click here](#) for full detail

Property features

Brand New Apartment | Wood floors | Neutral décor | Excellent storage | Parking | EPC-B | Excellent Light throughout | Two Balconies | High Specification | Close to Maida Vale Station

For more information about this property,
please call our Hampstead branch on

020 7435 9681

Redress & Client Money Protection :

Benham and Reeves are members of The Property Ombudsman redress scheme and have Client Money protection with ARLA Propertymark. You can find more information on our website at <https://www.benhams.com/membership/>



Benham & Reeves

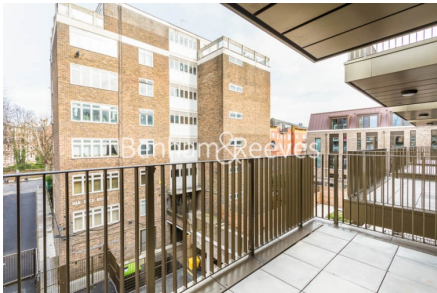

Masefield Court, Maida Vale, W9

£762 per week, £3,302 per month + fees

www.benhams.com

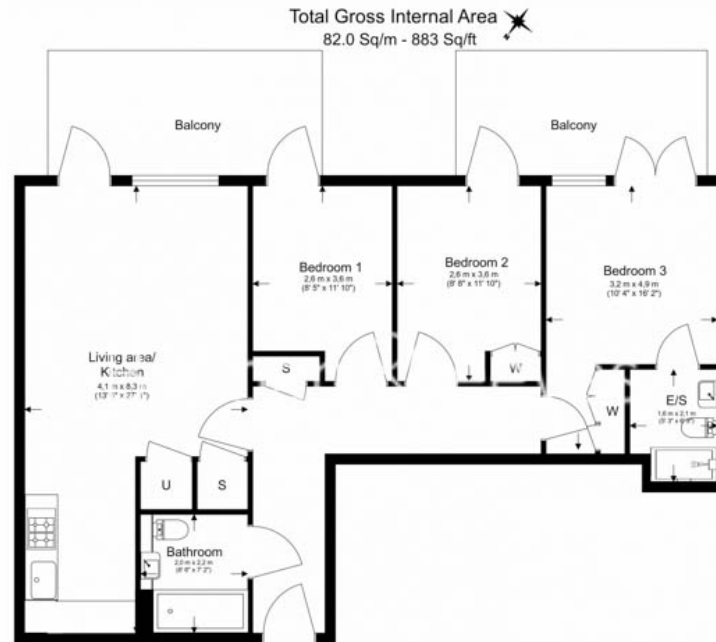

Floor Plan measurements are approximate and are for illustrative purposes only. While we do not doubt the floor plans accuracy, we make no guarantee, warranty or representation as to the accuracy and completeness of the floor plan.

London branches open six days a week Mon - Sat

Canary Wharf | City | Colindale | Dartmouth Park | Ealing | Fulham
Hammersmith | Hampstead | Highgate | Hyde Park | Kensington | Kew
Knightsbridge | Nine Elms | Shoreditch | Southall | Surrey Quays
Wapping | Wembley | White City | Woolwich

International offices

China | Hong Kong SAR | India | Indonesia | Qatar | Malaysia | Middle East | Pakistan
Singapore | South Africa | Thailand | Turkey



Benham & Reeves