



Benham & Reeves

Bryanston Street, Marble Arch W1H

£7,500 per week, £32,500 per month + fees

 3 Bedrooms  3 Bathrooms  Unfurnished

A truly exquisite, impeccable & sumptuous 3 bedrooms apartment with unparalleled 180° views of the London horizon sets on the 10th floor of the best residential building of Marble Arch - The Bryanston, emerged in the distinguished location of Hyde Park.

Please [click here](#) for full detail

Property features

3 x Bedrooms Apartment Designed by Millier London(10th Floor | 3 Luxury Marble Bathrooms (3 x En-Suite with Plenty of Stora | Large Open-Plan Reception Room with Panoramic Windows | Contemporary Kitchen integrated with Top-End Gaggenau & Sub | Furnished or Unfurnished /Home Automation System | EPC-B | Spans 2261 Sq Ft Internally / Air Cond. / Under Floor Heating | Private Terrace with 180° Panoramic View of London Horizon | Indoor Children Playground / Swimming Pool / Gym / Spa | 24 Hours Security / 24 Hours Concierge / Underground Parking

For more information about this property,
please call our Hyde Park branch on

020 7402 9866



Redress & Client Money Protection :

Benham and Reeves are members of The Property Ombudsman redress scheme and have Client Money protection with ARLA Propertymark. You can find more information on our website at <https://www.benhamandreeves.com/membership/>

Benham&Reeves



Bryanston Street, Marble Arch W1H

£7,500 per week, £32,500 per month + fees

www.benhams.com

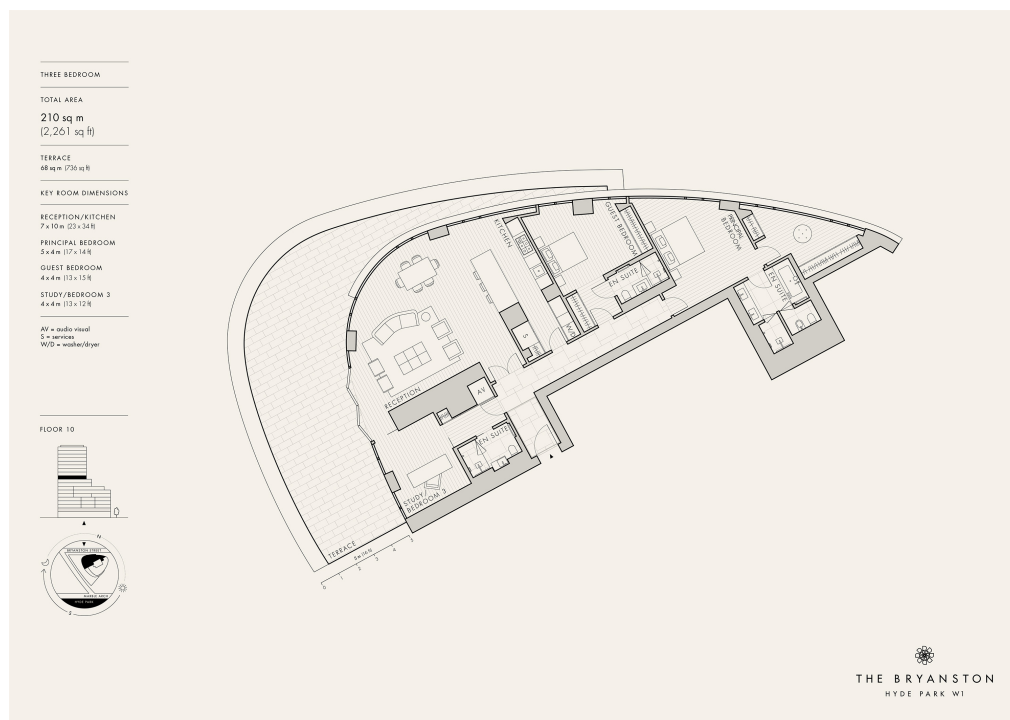

Score	Energy rating	Current	Potential
92+	A		
81-91	B	88 B	88 B
69-80	C		
55-68	D		
39-54	E		
21-38	F		
1-20	G		

London branches open six days a week Mon - Sat

Canary Wharf | City | Colindale | Dartmouth Park | Ealing | Fulham
Hammersmith | Hampstead | Highgate | Hyde Park | Kensington | Kew
Knightsbridge | Nine Elms | Shoreditch | Southall | Surrey Quays
Wapping | Wembley | White City | Woolwich

International offices

China | Hong Kong SAR | India | Indonesia | Qatar | Malaysia | Middle East | Pakistan
Singapore | South Africa | Thailand | Turkey



Benham & Reeves