



Benham & Reeves

**Pegaso Building, Nile Street, Hoxton, N1**

£530 per week, £2,297 per month + fees

 1 Bedroom    1 Bathroom    Furnished

Stylish apartment set within a highly sought-after apartment block 5 minutes from Old Street station and within easy reach of The City and Shoreditch.

Please [click here](#) for full detail

## Property features

**Modern 1 Bedroom Apartment | Bright Open Plan Reception | Fitted Kitchen with Integrated Appliances | Well Equipped Double Bedroom | Modern Family Size Bathroom | EPC-B | Wood Floors & Full-Length Windows Throughout | Furnished 618 Sq Ft Apartment | Close to The City, Shoreditch & Angel | Minutes from Old Street Station (Northern Line & Mainline Ra**

For more information about this property,  
please call our Property Management branch on

**020 7319 9740**

Redress & Client Money Protection :

Benham and Reeves are members of The Property Ombudsman redress scheme and have Client Money protection with ARLA Propertymark. You can find more information on our website at <https://www.benhamandreeves.com/membership/>



Benham&Reeves



# Pegaso Building, Nile Street, Hoxton, N1

£530 per week, £2,297 per month + fees

www.benhams.com

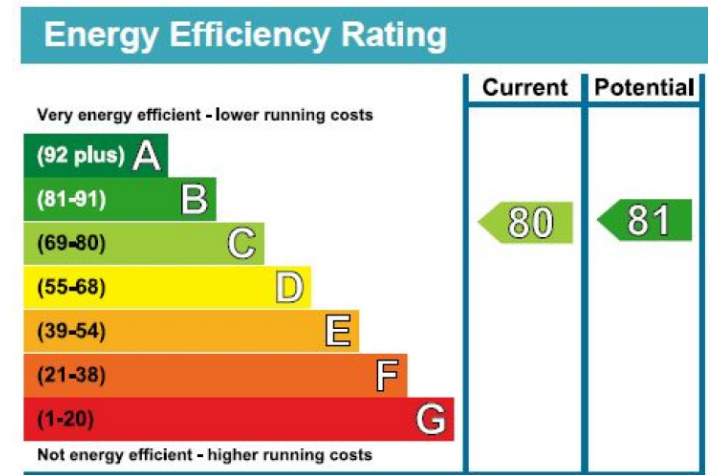
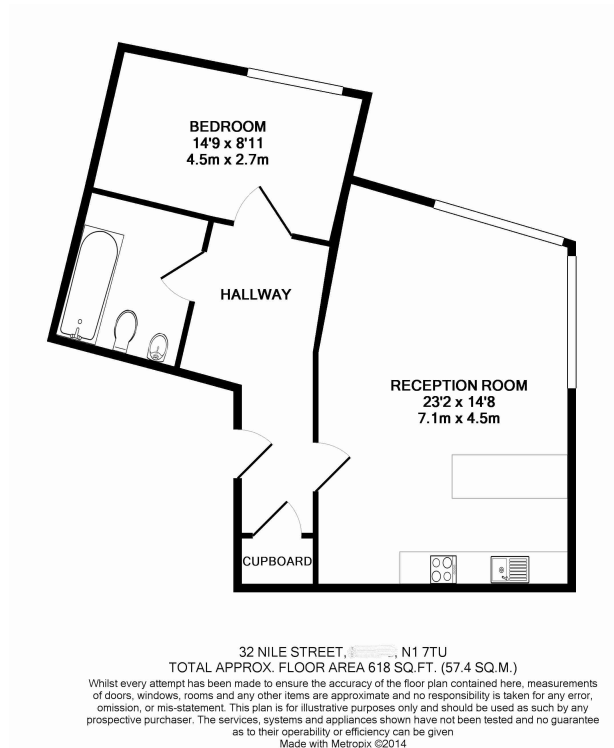

## London branches open six days a week Mon - Sat

Canary Wharf | City | Colindale | Dartmouth Park | Ealing | Fulham  
Hammersmith | Hampstead | Highgate | Hyde Park | Kensington | Kew  
Knightsbridge | Nine Elms | Shoreditch | Southall | Surrey Quays  
Wapping | Wembley | White City | Woolwich

## International offices

China | Hong Kong SAR | India | Indonesia | Qatar | Malaysia | Middle East |  
Singapore | South Africa | Thailand | Turkey



Benham & Reeves