



Benham & Reeves

## **Electric Boulevard, Nine Elms, SW11**

£1,215 per week, £5,265 per month + fees

 2 Bedrooms    2 Bathrooms    Unfurnished

A bright and spacious 12th floor apartment located in a popular development along the River Thames. Perfectly positioned for Battersea Power Station (Northern Line) and the Uber River Boat Service.

Please [click here](#) for full detail

## Property features

**Two bedrooms | Unfurnished | Winter Garden | Air cooling | 12 th floor | EPC-B | 24 hour concierge | Gym | Residence Lounge | Battersea Power Station Tube**

For more information about this property,  
please call our Nine Elms branch on

**020 3282 3700**

Redress & Client Money Protection :

Benham and Reeves are members of The Property Ombudsman redress scheme and have Client Money protection with ARLA Propertymark. You can find more information on our website at <https://www.benhamandreeves.com/membership/>



**Benham & Reeves**





# Electric Boulevard, Nine Elms, SW11

£1,215 per week, £5,265 per month + fees

www.benhams.com

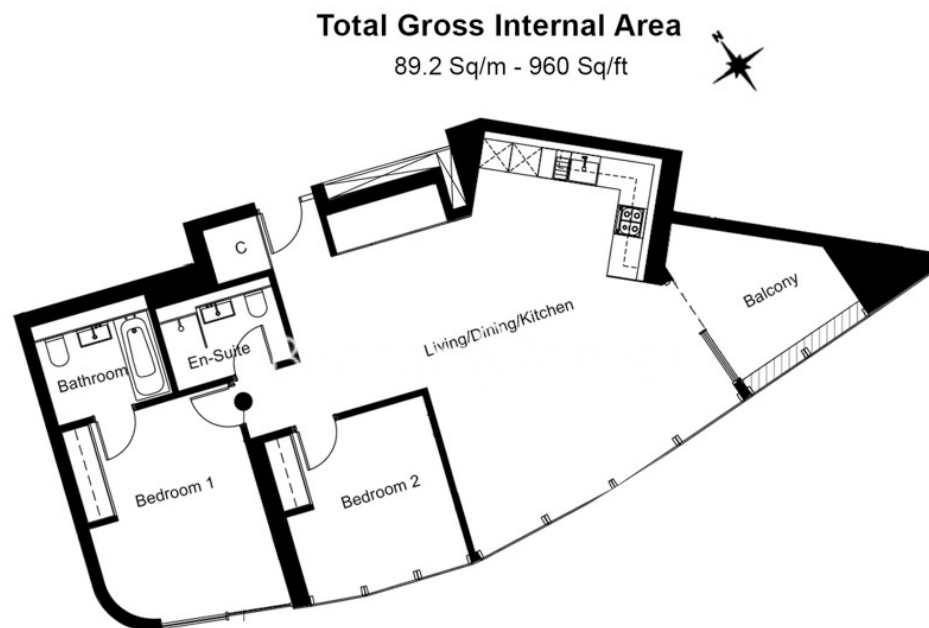

Floor Plan measurements are approximate and are for illustrative purposes only. While we do not doubt the floor plans accuracy, we make no guarantee, warranty or representation as to the accuracy and completeness of the floor plan.

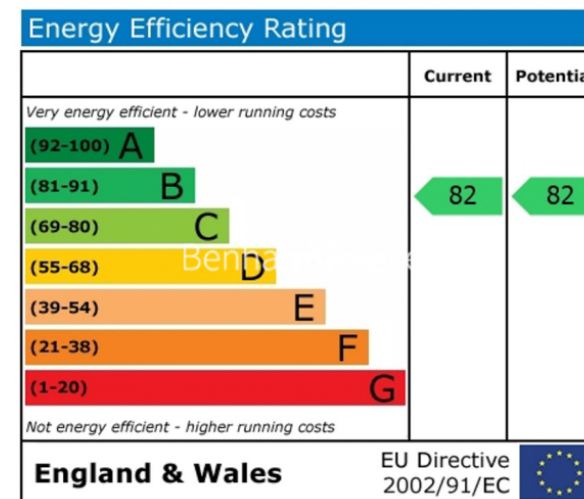

## London branches open six days a week Mon - Sat

Canary Wharf | City | Colindale | Dartmouth Park | Ealing | Fulham  
Hammersmith | Hampstead | Highgate | Hyde Park | Kensington | Kew  
Knightsbridge | Nine Elms | Shoreditch | Southall | Surrey Quays  
Wapping | Wembley | White City | Woolwich

## International offices

China | Hong Kong SAR | India | Indonesia | Qatar | Malaysia | Middle East | Pakistan  
Singapore | South Africa | Thailand | Turkey



Benham & Reeves