



Benham & Reeves

New Union Square, Nine Elms, SW11

£650 per week, £2,817 per month + fees

 1 Bedroom  1 Bathroom  Furnished

A wonderful, 1st floor apartment with private Balcony situated within a prestigious development conveniently located between Battersea and Vauxhall that offers an exclusive health club for residents. Residents benefit from 24-Hr Concierge, a Health Club, Swimming Pool, Business Centre & Cinema. The property is within walking distance to Vauxhall (Zone 2) underground station, which is serviced via the Victoria Line.

Please [click here](#) for full detail

Property features

Modern one bedroom | Balcony | High Spec Finish | Air Cooling | Fully fitted kitchen | EPC-B | Close to Amenities | 24 Hour Concierge | Close to River Thames

For more information about this property,
please call our Nine Elms branch on

020 3282 3700

Redress & Client Money Protection :

Benham and Reeves are members of The Property Ombudsman redress scheme and have Client Money protection with ARLA Propertymark. You can find more information on our website at <https://www.benhams.com/membership/>



Benham & Reeves

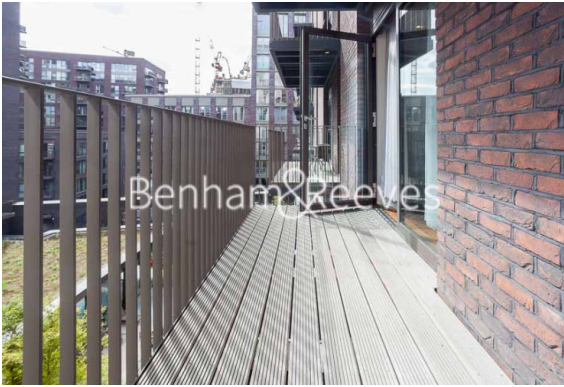

New Union Square, Nine Elms, SW11

£650 per week, £2,817 per month + fees

www.benhams.com

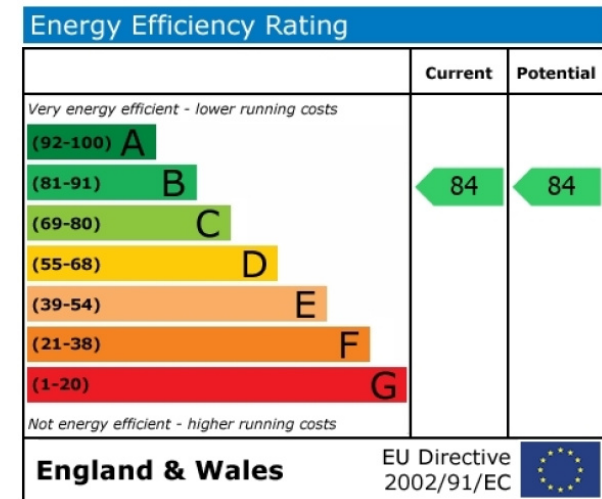
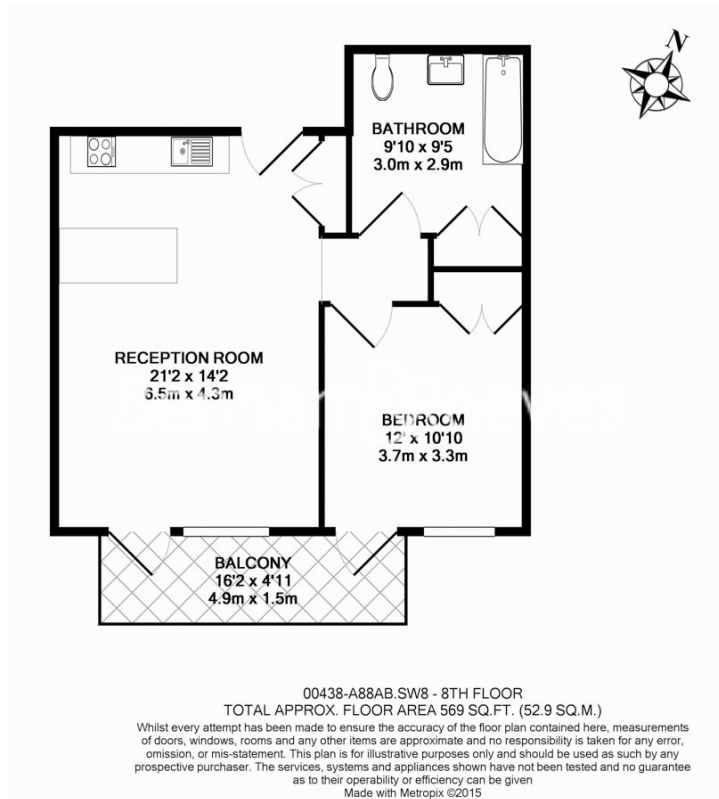

London branches open six days a week Mon - Sat

Canary Wharf | City | Colindale | Dartmouth Park | Ealing | Fulham
Hammersmith | Hampstead | Highgate | Hyde Park | Kensington | Kew
Knightsbridge | Nine Elms | Shoreditch | Southall | Surrey Quays
Wapping | Wembley | White City | Woolwich

International offices

China | Hong Kong SAR | India | Indonesia | Qatar | Malaysia | Middle East |
Singapore | South Africa | Thailand | Turkey



Benham & Reeves