



Benham & Reeves

Millbank, Nine Elms, SW1P

£1,050 per week, £4,550 per month + fees

 1 Bedroom  1 Bathroom  Furnished

A luxury apartment set in a Grade II listed building situated in a prestigious location off the River Thames and a short walk to Westminster Village. Moments from Westminster, St James, and Victoria Stations.

Please [click here](#) for full detail

Property features

Large one bedroom | Open planned living | High Spec Finish | Grade II listed building | Riverside development | EPC-B | 24 Hour concierge | Swimming Pool | Gym | Westminster Station

For more information about this property,
please call our Nine Elms branch on

020 3282 3700

Redress & Client Money Protection :

Benham and Reeves are members of The Property Ombudsman redress scheme and have Client Money protection with ARLA Propertymark. You can find more information on our website at <https://www.benhamandreeves.com/membership/>



Benham & Reeves



Millbank, Nine Elms, SW1P

£1,050 per week, £4,550 per month + fees

www.benhams.com

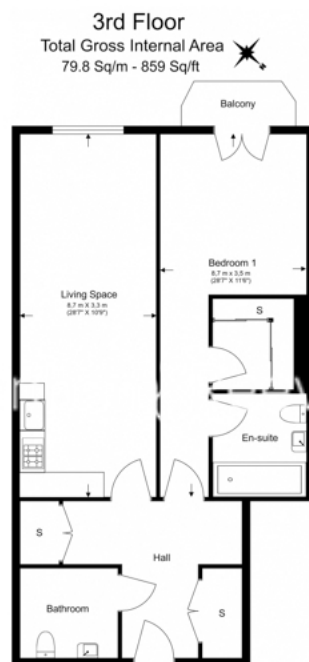

Floor Plan measurements are approximate and are for illustrative purposes only. While we do not doubt the floor plans accuracy, we make no guarantee, warranty or representation as to the accuracy and completeness of the floor plan.

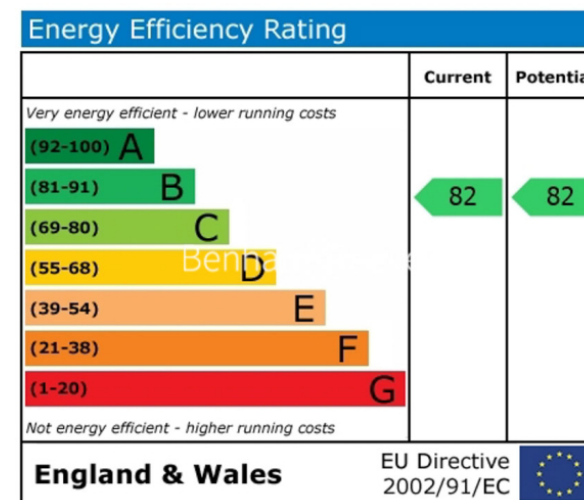

London branches open six days a week Mon - Sat

Canary Wharf | City | Colindale | Dartmouth Park | Ealing | Fulham
Hammersmith | Hampstead | Highgate | Hyde Park | Kensington | Kew
Knightsbridge | Nine Elms | Shoreditch | Southall | Surrey Quays
Wapping | Wembley | White City | Woolwich

International offices

China | Hong Kong SAR | India | Israel | Malaysia | Middle East | Pakistan
Qatar | Singapore | South Africa | Thailand | Turkey



Benham & Reeves