



Benham & Reeves

**Dean Bradley Street, Nine Elms, SW1P**

£1,550 per week, £6,717 per month + fees

 2 Bedrooms    1 Bathroom    Furnished

A spacious apartment situated in an historic Grade II listed building with 5\* resident's facilities, located off the River Thames and a short walk from Westminster Village, St James, and Victoria

Please [click here](#) for full detail

## Property features

**Large living space | High Spec | Fitted kitchen | Balcony | Furnished or Unfurnished | EPC-B | 24 Hour Concierge | Gym | Swimming pool | Westminster, St James Park and Victoria stations**

For more information about this property,  
please call our Nine Elms branch on

**020 3282 3700**

Redress & Client Money Protection :

Benham and Reeves are members of The Property Ombudsman redress scheme and have Client Money protection with ARLA Propertymark. You can find more information on our website at <https://www.benhamandreeves.com/membership/>



**Benham & Reeves**



# Dean Bradley Street, Nine Elms, SW1P

£1,550 per week, £6,717 per month + fees

[www.benhams.com](http://www.benhams.com)

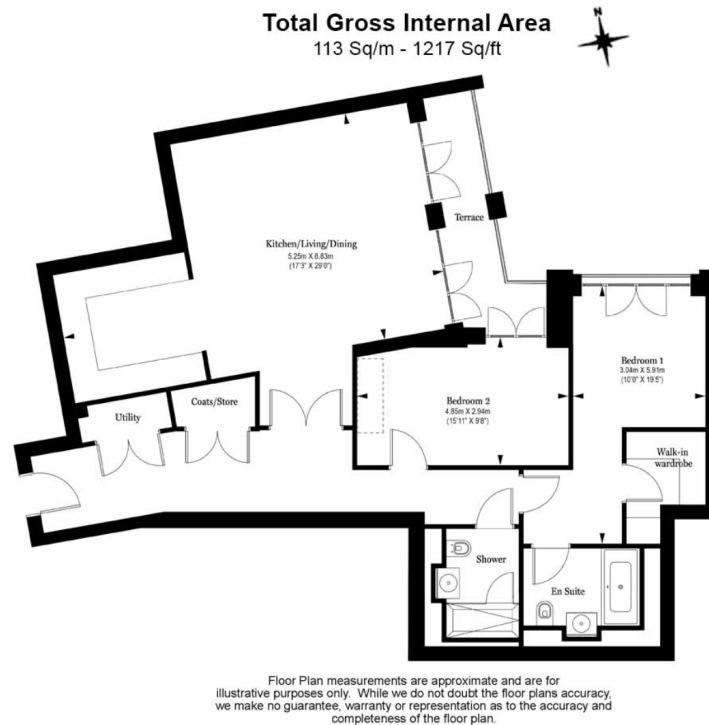

Energy Efficiency Rating		
	Current	Potential
Very energy efficient - lower running costs		
(92-100) A		
(81-91) B	82	82
(69-80) C		
(55-68) D		
(39-54) E		
(21-38) F		
(1-20) G		
Not energy efficient - higher running costs		
England & Wales	EU Directive 2002/91/EC	

## London branches open six days a week Mon - Sat

Canary Wharf | City | Colindale | Dartmouth Park | Ealing | Fulham  
Hammersmith | Hampstead | Highgate | Hyde Park | Kensington | Kew  
Knightsbridge | Nine Elms | Shoreditch | Southall | Surrey Quays  
Wapping | Wembley | White City | Woolwich

## International offices

China | Hong Kong SAR | India | Indonesia | Qatar | Malaysia | Middle East | Pakistan  
Singapore | South Africa | Thailand | Turkey



Benham & Reeves