



Benham & Reeves

Brent House, Nine Elms, SW8

£854 per week, £3,701 per month + fees

 2 Bedrooms  2 Bathrooms  Furnished

Bright, spacious apartment situated within a sought after development located next to Nine Elms Station (Northern Line) and a short walk from Vauxhall Station (Victoria Line).

Please [click here](#) for full detail

Property features

Two double bedrooms | Two bathrooms | Balcony | Furnished | Dishwasher | EPC-B | 24 hour concierge | Residence Gym | Supermarkets on site | Nine Elms tube station

For more information about this property, please call our Nine Elms branch on

020 3282 3700

Redress & Client Money Protection :

Benham and Reeves are members of The Property Ombudsman redress scheme and have Client Money protection with ARLA Propertymark. You can find more information on our website at <https://www.benhams.com/membership/>



Benham & Reeves



Brent House, Nine Elms, SW8

£854 per week, £3,701 per month + fees

www.benhams.com

Total Gross Internal Area
72.0 Sq/m - 775 Sq/ft

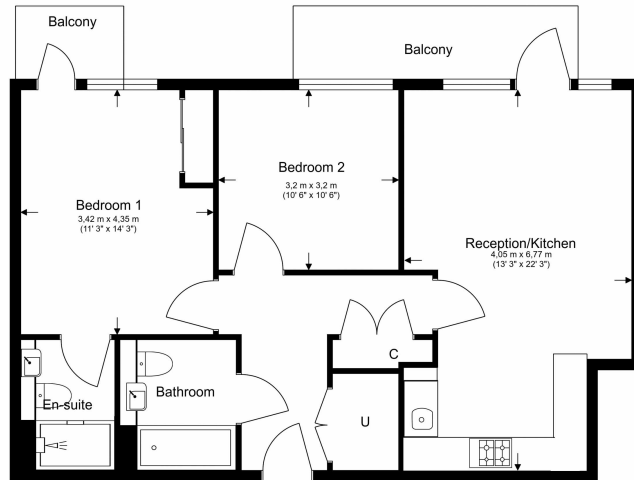

Benham & Reeves

Floor Plan measurements are approximate and are for illustrative purposes only. While we do not doubt the floor plans accuracy, we make no guarantee, warranty or representation as to the accuracy and completeness of the floor plan.

Score	Energy rating	Current	Potential
92+	A		
81-91	B	86 B	86 B
69-80	C		
55-68	D		
39-54	E		
21-38	F		
1-20	G		

London branches open six days a week Mon - Sat

Canary Wharf | City | Colindale | Dartmouth Park | Ealing | Fulham
Hammersmith | Hampstead | Highgate | Hyde Park | Kensington | Kew
Knightsbridge | Nine Elms | Shoreditch | Southall | Surrey Quays
Wapping | Wembley | White City | Woolwich

International offices

China | Hong Kong SAR | India | Indonesia | Qatar | Malaysia | Middle East |
Singapore | South Africa | Thailand | Turkey



Benham & Reeves