



Benham & Reeves

## **Regency House, North West Quarter, NW6**

£750 per week, £3,250 per month + fees

 2 Bedrooms    2 Bathrooms    Furnished

This exceptional 5th floor is situated on the fifth floor of the highly sought-after West Hampstead Central development. Located in Zone 2 and a 7-minute walk from Queen's Park station on the Bakerloo line.

Please [click here](#) for full detail

## Property features

**Spacious Two Double Bedrooms | Two Modern Bathrooms | Private Balcony with Scenic Views | On-Site Facilities | Concierge Service | EPC-TBC | Prime Zone 2 Location | High-Quality Finishes, including underfloor heating | Home Office-Ready, featuring super-fast Hyperoptic Broadband | Nearby Queen's Park station**

For more information about this property,  
please call our Hampstead branch on

**020 7435 9681**

Redress & Client Money Protection :

Benham and Reeves are members of The Property Ombudsman redress scheme and have Client Money protection with ARLA Propertymark. You can find more information on our website at <https://www.benhams.com/membership/>



Benham&Reeves



# Regency House, North West Quarter, NW6

£750 per week, £3,250 per month + fees

[www.benhams.com](http://www.benhams.com)

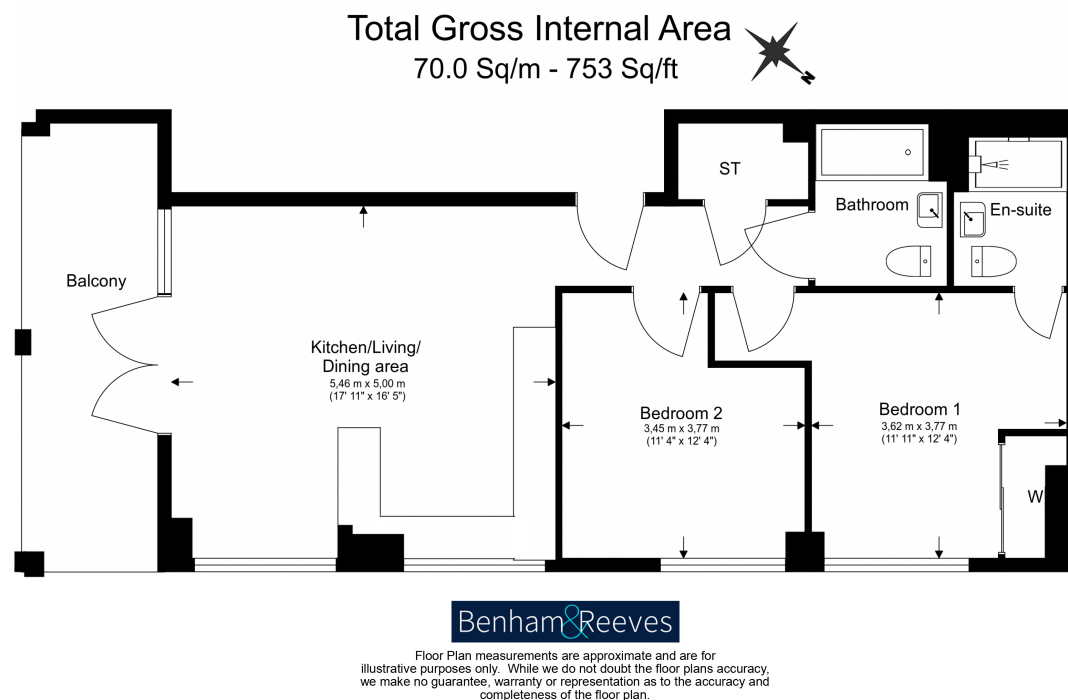

## London branches open six days a week Mon - Sat

Canary Wharf | City | Colindale | Dartmouth Park | Ealing | Fulham  
Hammersmith | Hampstead | Highgate | Hyde Park | Kensington | Kew  
Knightsbridge | Nine Elms | Shoreditch | Southall | Surrey Quays  
Wapping | Wembley | White City | Woolwich

## International offices

China | Hong Kong SAR | India | Indonesia | Qatar | Malaysia | Middle East |  
Singapore | South Africa | Thailand | Turkey



**Benham & Reeves**