



Benham & Reeves

Portobello Square, Notting Hill, W10

£450 per week, £1,950 per month + fees

🛏 1 Bedroom 🚿 1 Bathroom 🛋 Furnished

Portobello's first major new development in more than 30 years. All the apartments within the award winning Portobello Square are beautifully designed to maximize space, with high quality detailing and materials that capture the vibrancy of the area.

Please [click here](#) for full detail

Property features

1 Bedroom | 1 Bathroom | Reception | Furnished | Fitted Kitchen | EPC-C | Under Floor Heating | Wooden Flooring | Nearby Ladbroke Grove Tube Station

For more information about this property,
please call our Hyde Park branch on

020 7402 9866





Portobello Square, Notting Hill, W10

£450 per week, £1,950 per month + fees

www.benhams.com

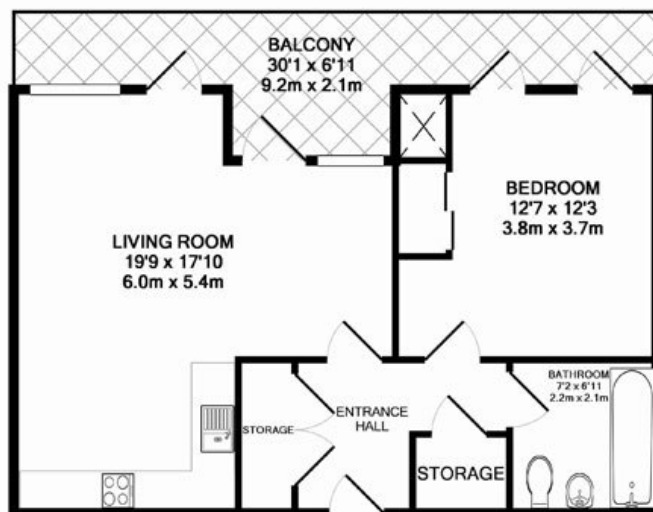

PORTOBELLO SQUARE, W10
TOTAL APPROX. FLOOR AREA 569 SQ.FT. (52.8 SQ.M.)

Whilst every attempt has been made to ensure the accuracy of the floor plan contained here, measurements of doors, windows, rooms and any other items are approximate and no responsibility is taken for any error, omission, or mis-statement. This plan is for illustrative purposes only and should be used as such by any prospective purchaser. The services, systems and appliances shown have not been tested and no guarantee as to their operability or efficiency can be given.
Made with Metropix ©2013

Energy Efficiency Rating

	Current	Potential
Very energy efficient - lower running costs		
(92 plus) A		
(81-91) B		
(69-80) C	77	77
(55-68) D		
(39-54) E		
(21-38) F		
(1-20) G		
Not energy efficient - higher running costs		

London branches open six days a week Mon - Sat

Canary Wharf | City | Colindale | Dartmouth Park | Ealing | Fulham
Hammersmith | Hampstead | Highgate | Hyde Park | Kensington | Kew
Knightsbridge | Nine Elms | Shoreditch | Southall | Surrey Quays
Wapping | Wembley | White City | Woolwich

International offices

China | Hong Kong SAR | India | Indonesia | Qatar | Malaysia | Middle East |
Singapore | South Africa | Thailand | Turkey



Benham & Reeves