



Benham & Reeves

## **Camden Courtyards, Rochester Place, Camden NW1**

£750 per week, £3,250 per month + fees

🛏 2 Bedrooms    🚿 2 Bathrooms    🛋 Unfurnished

A contemporary 2 double bedroom apartment set within the heart of Camden Town; popular development named - Camden Courtyards. The property's sought-after location in the heart of central London means there are an abundance of nearby travel stations. EPC-B

Please [click here](#) for full detail

## Property features

EPC B

For more information about this property,  
please call our Hyde Park branch on

**020 7402 9866**

Redress & Client Money Protection :

Benham and Reeves are members of The Property Ombudsman redress scheme and have Client Money protection with ARLA Propertymark. You can find more information on our website at <https://www.benhams.com/membership/>

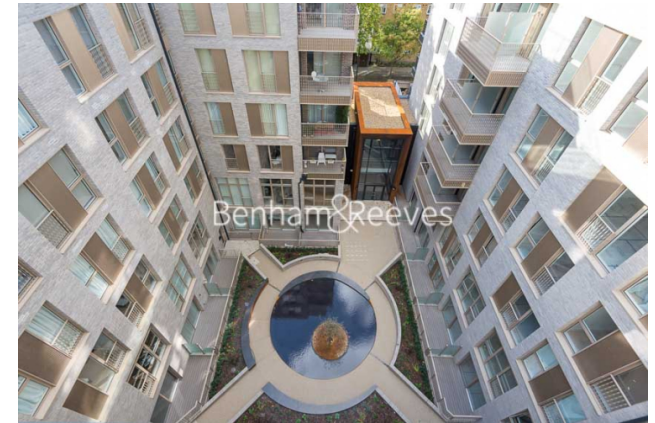

Benham & Reeves





# Camden Courtyards, Rochester Place, Camden NW1

www.benhams.com

£750 per week, £3,250 per month + fees

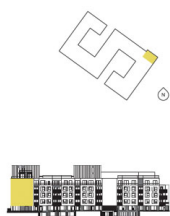

Bennett House

Living/Dining/Kitchen  
19'1" x 15'0" (5800 x 4600mm)  
Master Bedroom  
14'4" x 9'9" (4300 x 3000mm)  
Bedroom 2  
14'2" x 9'5" (4300 x 2900mm)  
TOTAL AREA  
770.5 sq ft (71.6 sq m)  
Balcony  
12'9" x 5'1" (3900 x 1600mm)

Score	Energy rating	Current	Potential
92+	A		
81-91	B	84 B	84 B
69-80	C		
55-68	D		
39-54	E		
21-38	F		
1-20	G		

## London branches open six days a week Mon - Sat

Canary Wharf | City | Colindale | Dartmouth Park | Ealing | Fulham  
Hammersmith | Hampstead | Highgate | Hyde Park | Kensington | Kew  
Knightsbridge | Nine Elms | Shoreditch | Southall | Surrey Quays  
Wapping | Wembley | White City | Woolwich

## International offices

China | Hong Kong SAR | India | Israel | Malaysia | Middle East | Pakistan  
Qatar | Singapore | South Africa | Thailand | Turkey



Benham & Reeves