



Benham & Reeves

**Brigadier Walk, Royal Arsenal Riverside, SE18**

£646 per week, £2,800 per month + fees

 2 Bedrooms    2 Bathrooms    Furnished

Spacious apartment offering North/West aspects and direct views of the River Thames situated within a magnificent new development on the cusp of the River and four-acre Maribor Park. The new on-site Elizabeth Line station now open, journey times into the City, West and Heathrow Airport are faster than ever before.

Please [click here](#) for full detail

## Property features

**Stunning 2 Bedroom Riverside Apartment | Spacious Private Balcony With Direct River Views | Bright and Airy Spaces with Open Plan Layout | Dual Aspects with views of the River Thames | High Quality Specifications Including Integrated Siemens | EPC-B | Swimming pool, gymnasium, spa, cinema | 24 hours concierge | Moments to Woolwich Tube Station**

For more information about this property,  
please call our Woolwich branch on

**020 8051 0700**

Redress & Client Money Protection :

Benham and Reeves are members of The Property Ombudsman redress scheme and have Client Money protection with ARLA Propertymark. You can find more information on our website at <https://www.benhams.com/membership/>



**Benham & Reeves**



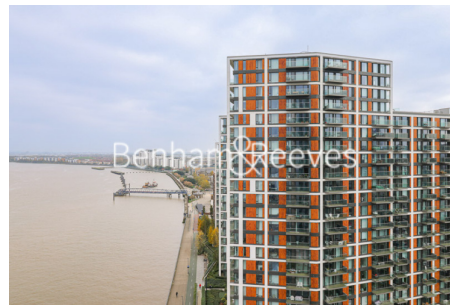

# Brigadier Walk, Royal Arsenal Riverside, SE18

£646 per week, £2,800 per month + fees

www.benhams.com

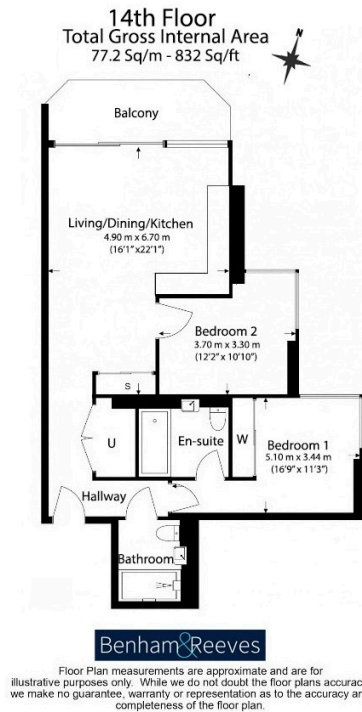

Score	Energy rating	Current	Potential
92+	A		
81-91	B	85 B	85 B
69-80	C		
55-68	D		
39-54	E		
21-38	F		
1-20	G		

## London branches open six days a week Mon - Sat

Canary Wharf | City | Colindale | Dartmouth Park | Ealing | Fulham  
Hammersmith | Hampstead | Highgate | Hyde Park | Kensington | Kew  
Knightsbridge | Nine Elms | Shoreditch | Southall | Surrey Quays  
Wapping | Wembley | White City | Woolwich

## International offices

China | Hong Kong SAR | India | Indonesia | Qatar | Malaysia | Middle East | Pakistan  
Singapore | South Africa | Thailand | Turkey



Benham & Reeves