



Benham & Reeves

## **Chelsea Cloisters, Sloane Avenue SW3**

£550 per week, £2,383 per month + fees

 1 Bedroom    1 Bathroom    Furnished

A well-appointed 384 sq ft ONE-BEDROOM apartment on the 4th Floor of CHELSEA CLOISTERS on Sloane Avenue. Residents benefit from 24-Hr Concierge & close proximity to chic boutiques, restaurants & bars. Rent includes HOT WATER & HEATING. South Kensington Station is a 5 minute walk.

Please [click here](#) for full detail

## Property features

**1 Bedroom | 1 Bathroom | 24 Hr Concierge | Furnished | Hot Water & Heating Included | EPC-C | 384 Sq Ft | Separate Fitted Kitchen | Hot Water & Heating Included | Nearby South Kensington and Sloane Square Tube Stations**

For more information about this property,  
please call our Knightsbridge branch on

**020 7581 2112**

Redress & Client Money Protection :

Benham and Reeves are members of The Property Ombudsman redress scheme and have Client Money protection with ARLA Propertymark. You can find more information on our website at <https://www.benhams.com/membership/>



**Benham & Reeves**



# Chelsea Cloisters, Sloane Avenue SW3

£550 per week, £2,383 per month + fees

[www.benhams.com](http://www.benhams.com)

Chelsea Cloisters  
Approx. Gross Internal Area 384 Sq Ft - 35.67 Sq M

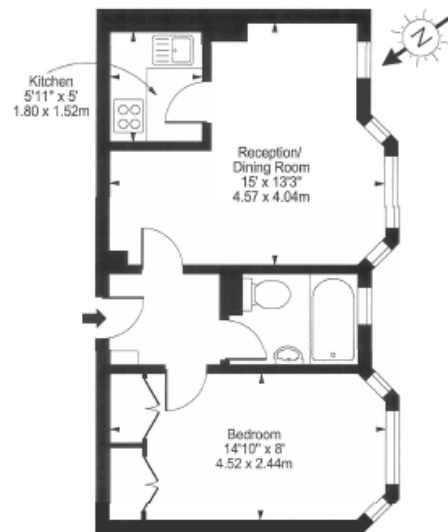

Sixth Floor

For Illustration Purposes Only - Not To Scale Floor Plan by Humble Spy Photography Ltd.  
This floor plan should be used as a general outline for guidance only and does not constitute in whole or in part an offer or contract.  
Any intending purchaser or lessee should satisfy themselves by inspection, valuations, enquiries and full survey as to the correctness of each statement.  
Any areas, measurements or distances quoted are approximate and should not be used to value a property or be the basis of any sale or let.

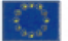
Energy Efficiency Rating		
	Current	Potential
Very energy efficient - lower running costs		
(92-100) <b>A</b>		
(81-91) <b>B</b>		
(69-80) <b>C</b>	74	81
(55-68) <b>D</b>		
(39-54) <b>E</b>		
(21-38) <b>F</b>		
(1-20) <b>G</b>		
Not energy efficient - higher running costs		
England & Wales		EU Directive 2002/91/EC 

## London branches open six days a week Mon - Sat

Canary Wharf | City | Colindale | Dartmouth Park | Ealing | Fulham  
Hammersmith | Hampstead | Highgate | Hyde Park | Kensington | Kew  
Knightsbridge | Nine Elms | Shoreditch | Southall | Surrey Quays  
Wapping | Wembley | White City | Woolwich

## International offices

China | Hong Kong SAR | India | Indonesia | Qatar | Malaysia | Middle East | Pakistan  
Singapore | South Africa | Thailand | Turkey



Benham & Reeves